

9300 73rd Ave N.
Brooklyn Park, MN 55428

Toll-Free: 800-547-2635
Fax 800-317-8770



Right to site.

Direct Phone: 763-488-9200
Direct Fax: 763-488-9201

e-mail: info@nystrom.com
Internet: www.nystrom.com

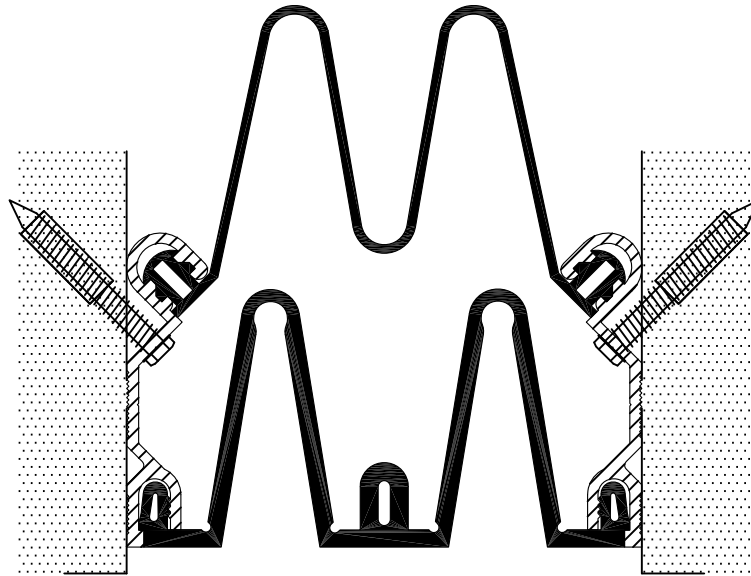

Finish Seal – Standard Series
Model(s) "EJ-EWN-200/300/400/500/600"
Vertical Expansion Control Systems

The following installation procedure is very important and must be fully understood prior to beginning any work. To ensure proper installation and performance of expansion joint system the following actions must be completed by the installing contractor. Failure to do so will affect product warranty.

- 1) Carefully read and understand installation procedure. Contact Technical Service Department for product assistance.
- 2) Inspect all shipments and materials for missing or damaged components and hardware. Contact Customer Service with order number and invoice for prompt assistance.
- 3) Inspect substrate or adjacent construction for acceptance before beginning work. Report unacceptable construction to the project manager for scheduled repair work.

PN: 28071A

Standard Components



Wall Mount Extrusion
Part Number-27463



ø3/16" Tapcon screw
Part Number-27529

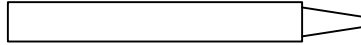

*Sikaflex 1A
(by others)

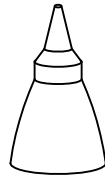

**SI 750 Adhesive
Part Number - 27514

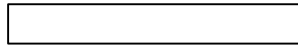

**Butt splice clip
Part Number-27511

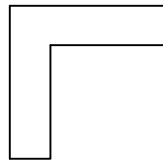

**Splice clip: same plane

*Add'l components needed for Adhesive installation. Place order for required quantities.

**Optional components for splice procedures. Place order for required quantities.

Components shown below vary in size depending on model of system

Visual Seal Part Number				
Model	Black Seal	White Seal	Grey Seal	Beige Seal
EJ-EWN-200	28009	28010	28011	28012
EJ-EWN-300	28013	28014	28015	28016
EJ-EWN-400	28017	28018	28019	28020
EJ-EWN-500	28021	28022	28023	28024
EJ-EWN-600	28025	28026	28027	28028

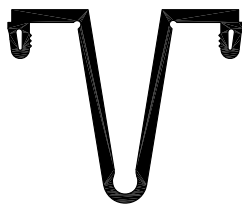

EJ-EWN-200



EJ-EWN-300

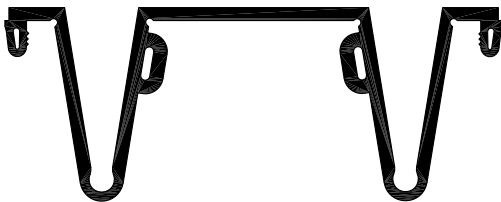

EJ-EWN-400
EJ-EWN-500



EJ-EWN-600

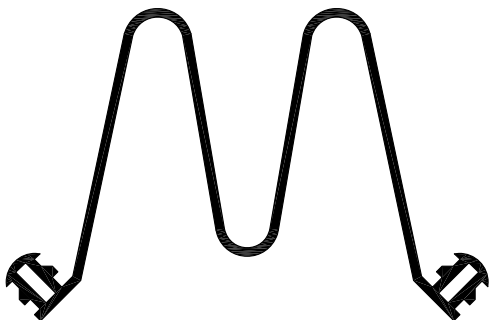

MOISTURE BARRIER PN 28029
EJ-EWN-200/300/400

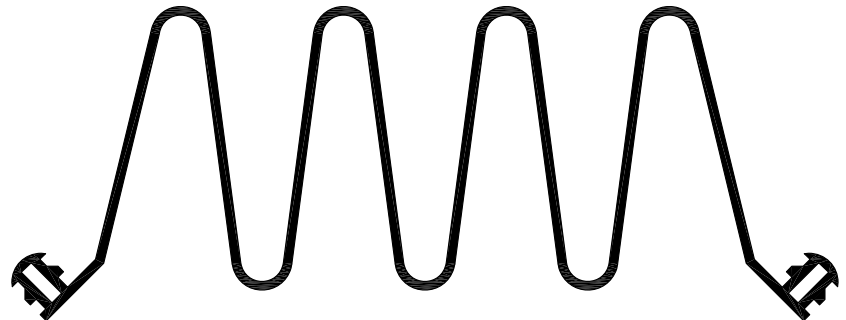

MOISTURE BARRIER PN 28030
EJ-EWN-500/600

Standard Installation Exterior only

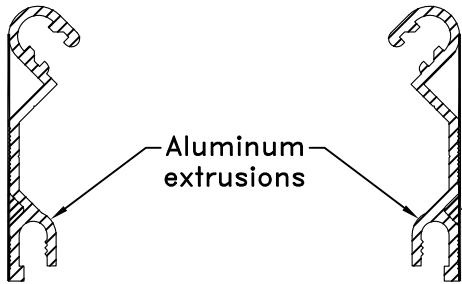

Sikaflex 1A
(by others)

Adhesive Installation

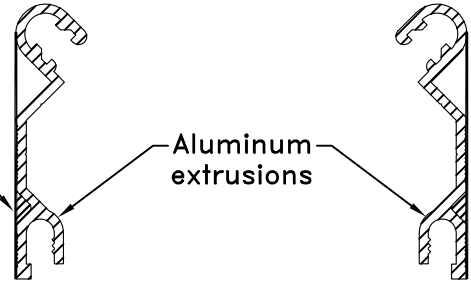

1

Apply adhesive along back of the aluminum extrusions prior to installation. (following adhesive manufacturers guidelines).

Note: Adhesive manufacturer may require coating adjacent surfaces, verify with adhesive manufacturer prior to proceeding.

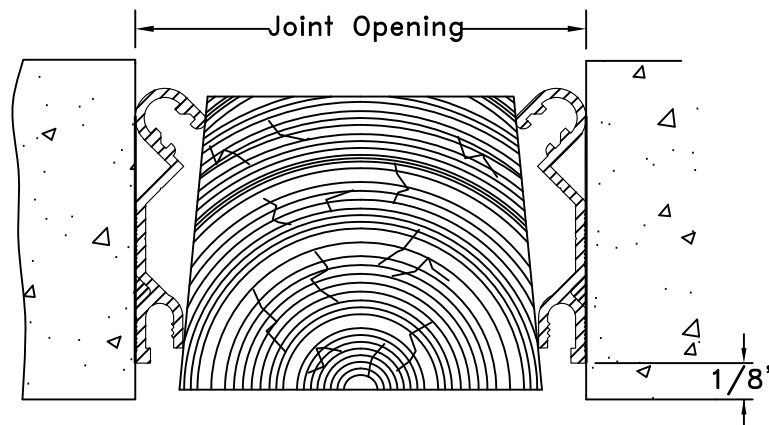

2

Field measure all lengths and directional changes for aluminum extrusions to ensure their proper layout where required. Mount extrusions to wall surface and install temporary wood blocking to secure extrusions to wall while adhesive cures and for field drilling for standard installation. Wood blocking should be non-continuous to permit field drilling of anchor holes at required spacing. Contact adhesive manufacturer for proper cure times before proceeding to next step.

***Note:** Always review architectural plans for specific project requirements

NOTE:

- For standard installation, continue to step 3.
- For Adhesive installation go to step 5.

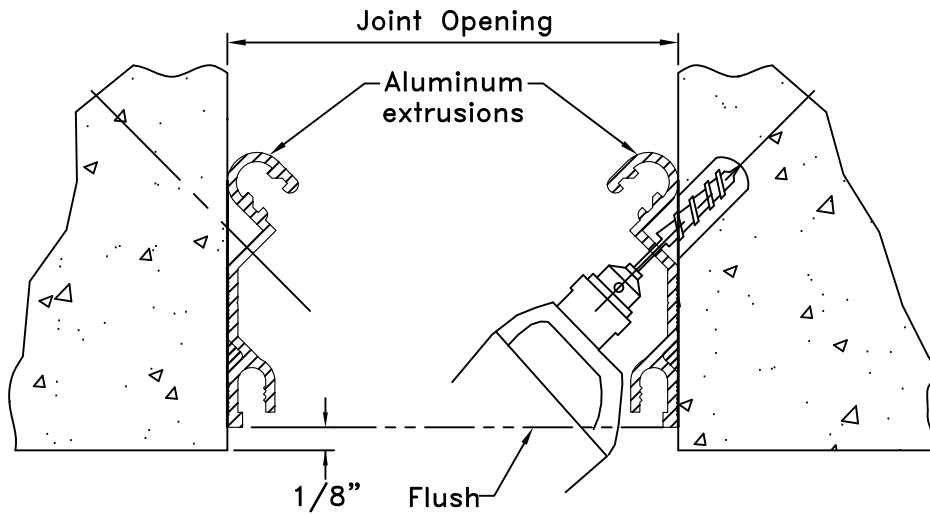

3 Position aluminum extrusions and mark hole locations. Drill holes through aluminum flange and into wall for $\varnothing 3/16$ " Tapcon screws @ 18" O.C.

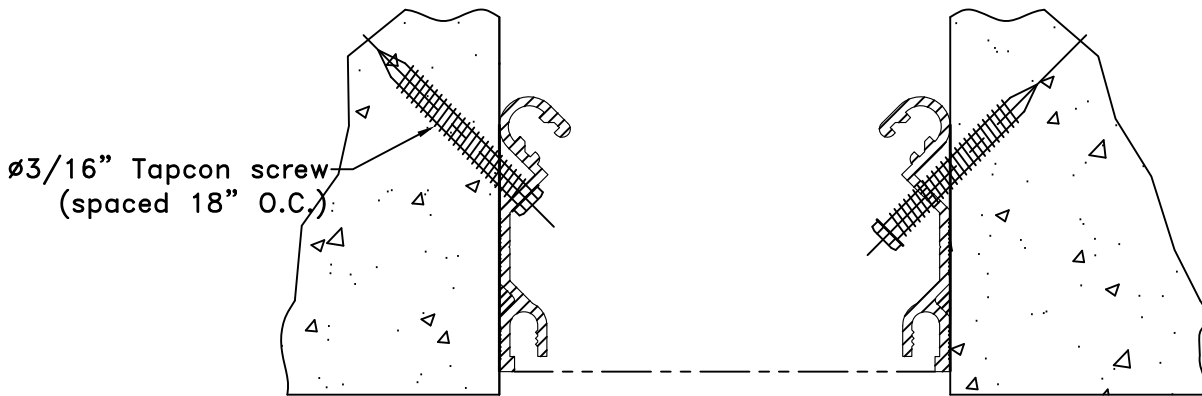

4 Secure aluminum extrusions to wall with $\varnothing 3/16$ " Tapcon screws @ 18" O.C.

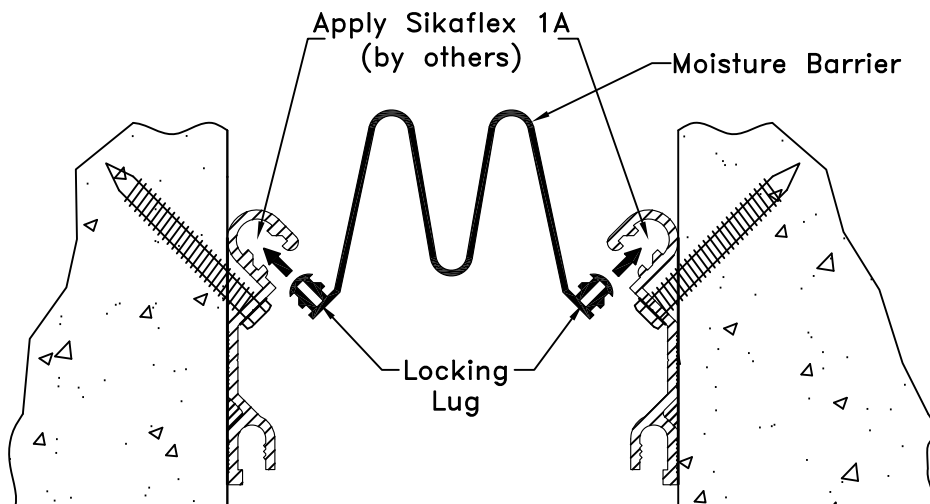

5 Before installing moisture barrier, apply Sikaflex 1A adhesive to rear locking cavities of the aluminum extrusions. Ensure full engagement of locking lug.

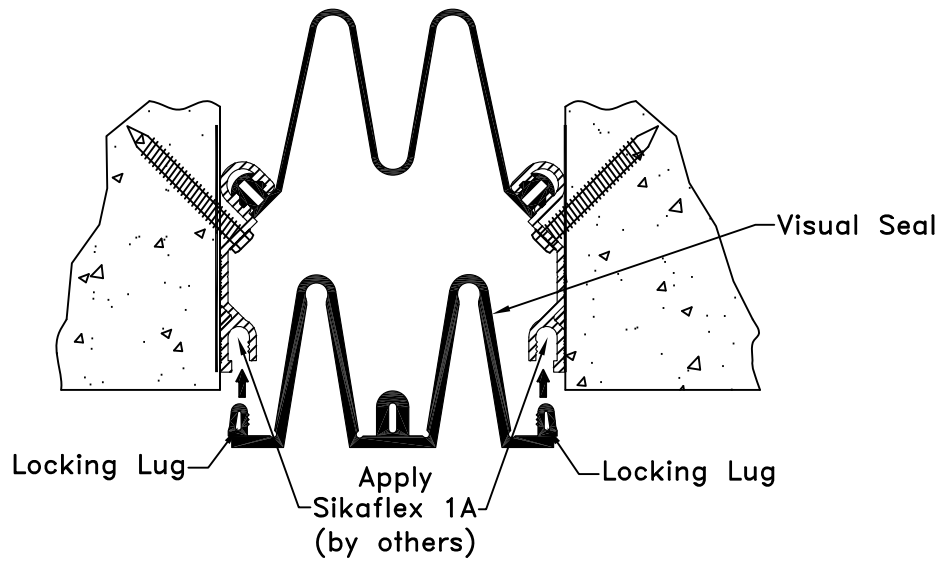

6 Before installing visual seal apply Sikaflex 1A adhesive into front locking cavities of aluminum extrusions. Ensure full engagement of locking lug.

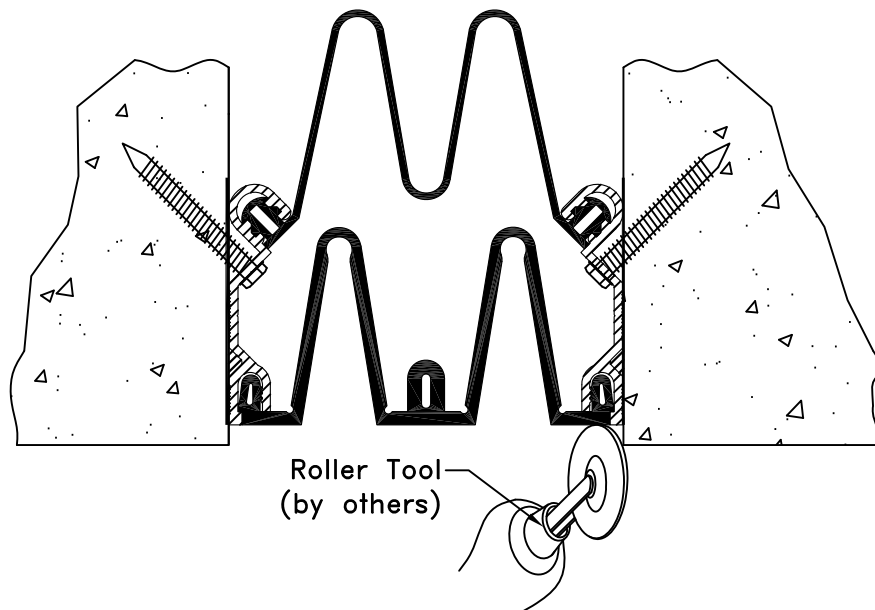

7 Utilizing roller tool apply pressure directly over locking lug to ensure proper engagement of seal lug.

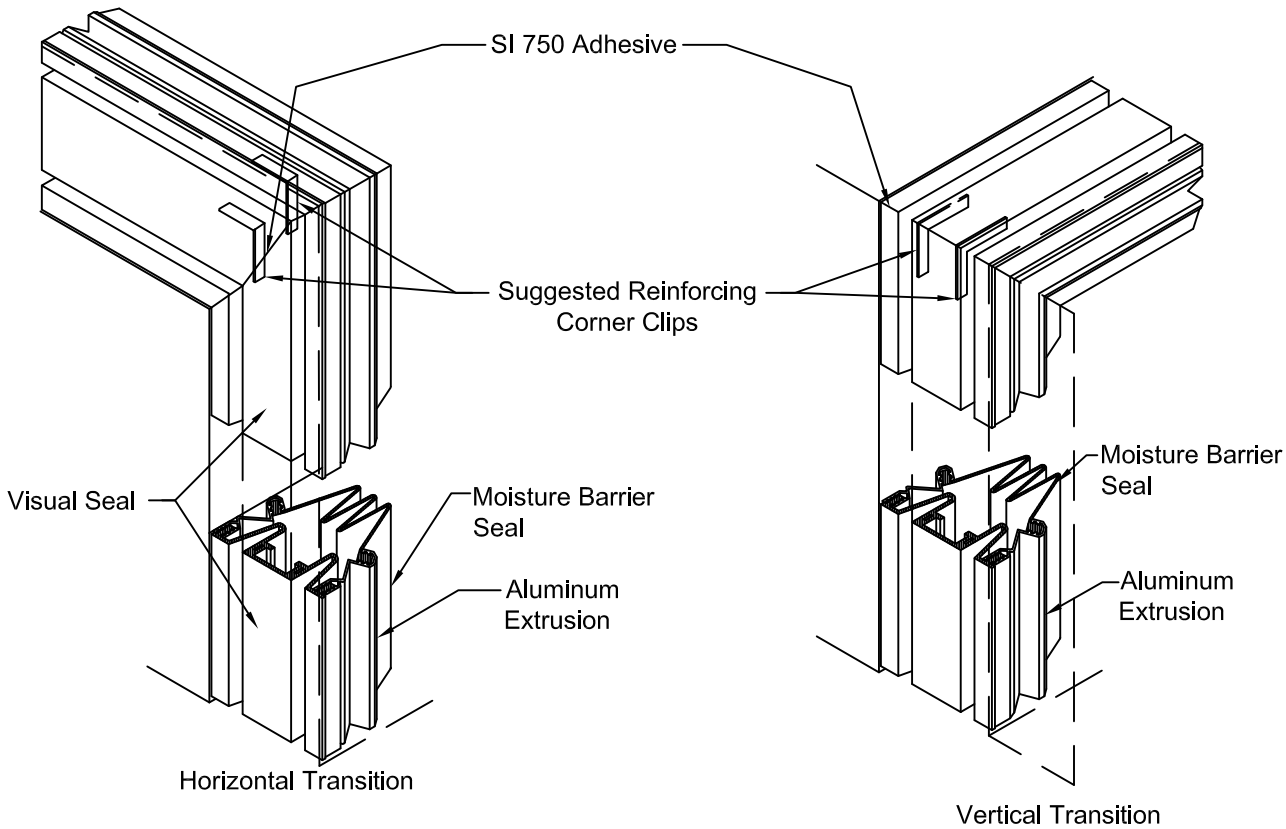

"EJ-EWN" Visual Seal Field Splice Procedures

Used for direction changes, Going around corners, Parapets, Etc
(Santoprene Only)

1. Cut ends of the visual seal, with a sharp knife, to the desired angle using a formed jig with miter box (supplied by contractor). Insure cuts are clean, straight and square.
2. Cleans ends of seal with a solvent to remove any foreign material.
3. Reassemble mitered ends of adjacent seals utilizing the reinforcing corner clips (for 90° transitions only).
4. Apply adhesive as specified by the manufacturer to one of the two seal surfaces to be bonded.
5. Apply pressure bringing the two surfaces in tight contact immediately upon completing application of the adhesive. Hold in place for approximately one to two minutes to allow adhesion.
6. Re-check quality of all miters or splices and apply additional adhesive if required to ensure proper miter or splice.
7. Contact manufacturer for clarification of above procedure (if required) prior to proceeding with splicing visual seal profile. It is usually recommended to allow 15 minutes time before installing spliced seal. Care shall be excercised as a result that it takes 24 hours for adhesive to fully cure.