

**SPECIFICATIONS:**

- ① **DOOR:** ALUMINUM, 1/4" DIAMOND PLATE, MILL FINISH WITH A LIVE LOAD OF 300 PSF WITH A MAX SPAN DEFLECTION OF L/150
- ② **FRAME:** ALUMINUM, 1/4" EXTRUSION, GRAY PRIMER FINISH ON EXTERIOR SURFACES THAT COME IN CONTACT WITH CONCRETE
- ③ **HINGES:** TYPE 316 STAINLESS STEEL
- ④ **SLAM LATCH:** TYPE 316 STAINLESS STEEL WITH INSIDE LEVER HANDLE AND OUTSIDE REMOVABLE 5/16" SQUARE L HANDLE
- ⑤ **COUNTER-BALANCE SPRING:** ENCLOSED, TYPE 17-7 SST SPRING
- ⑥ **HOLD-OPEN ARM:** TYPE 316 STAINLESS STEEL WITH RED VINYL GRIP HANDLE
- ⑦ **GASKET:** EPDM
- ⑧ **SAFETY GRATE:** ALUMINUM, 6" SERRATED RAILS WITH SAFETY ORANGE POWDER COAT, LIVE LOAD OF 300PSF, SST HINGES AND INTEGRAL PADLOCK HASP
- ⑨ **NUT RAIL:** ALUMINUM NUT RAIL ON HINGE AND LATCH SIDES

**FLOOR DOOR SIZE:**

PROPRIETARY AND CONFIDENTIAL: THE INFORMATION CONTAINED IN THIS DRAWING IS THE SOLE PROPERTY OF NYSTROM. ANY REPRODUCTION IN PART OR AS A WHOLE WITHOUT THE WRITTEN PERMISSION OF NYSTROM IS PROHIBITED. THIS SHOP DRAWING MAY NOT BE AN ACTUAL REPRESENTATION OF THE FINAL PRODUCT.

PROJECT:				
ARCHITECT:				
CONTRACTOR:				
QTY:				
PART#:	.....			
<b>nystrom</b> 9300 73rd Avenue North Minneapolis, MN 55428	<b>TITLE:</b> Floor Door, Non-Drainable Series Engl Dr, 316 SST Hdw, Alum, Mill, Pedestrian, Cast-In, Slam Latch Removable L Hdl			
NAME	DATE	SIZE	DWG. NO.	REV
DRAWN JPB	3-31-17	A	Nystrom FD 00BUCY U08-SGT ShpDr	A
RELEASED TR	3-31-17	WEIGHT:		SHEET 1 OF 2

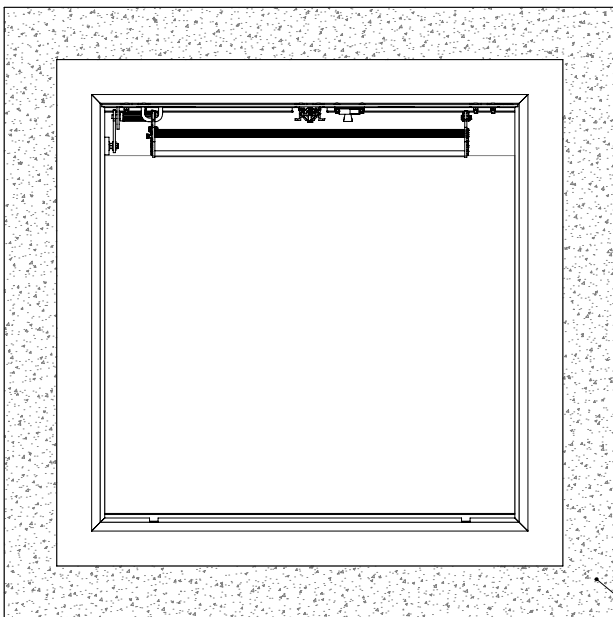

CONCRETE

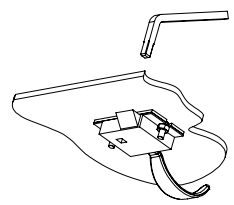
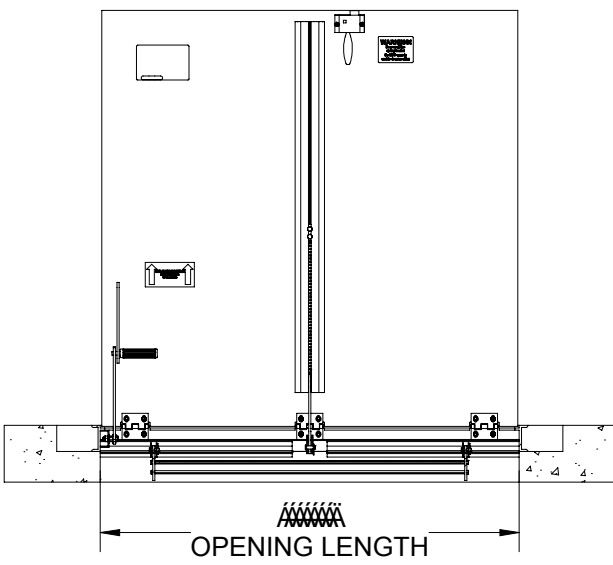
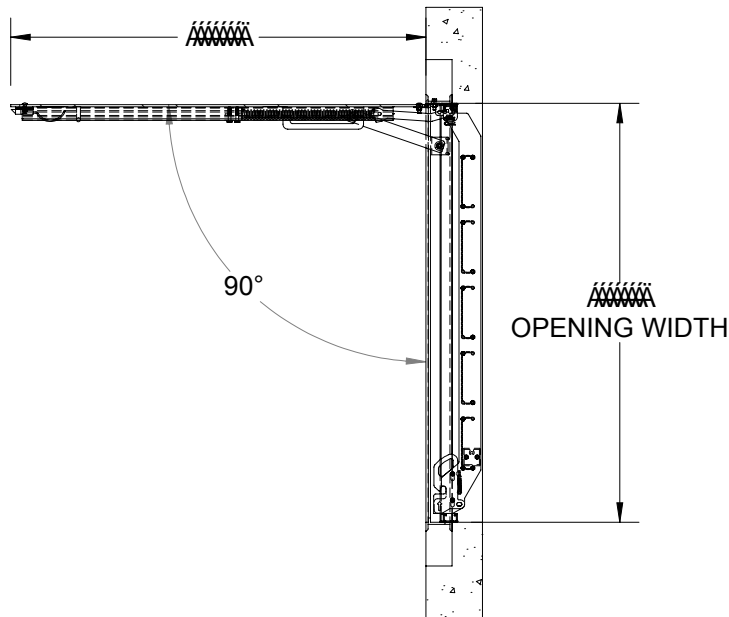

SLAM LATCH DETAIL

			TITLE: Floor Door, Non-Drainable Series, Sngl Dr, 316 SST Hdw, Alum, Mill, Pedestrian, Cast-In, Slam Latch, Removable L Hdl		
9300 73rd Avenue North Minneapolis, MN 55428			SIZE	DWG. NO.	REV
DRAWN	JPB	3-31-17	A	Nystrom FD 00BUCY U08-SGT ShpDr	A
RELEASED	TR	3-31-17	WEIGHT:	SHEET 2 OF 2	

PROPRIETARY AND CONFIDENTIAL: THE INFORMATION CONTAINED IN THIS DRAWING IS THE SOLE PROPERTY OF NYSTROM. ANY REPRODUCTION IN PART OR AS A WHOLE WITHOUT THE WRITTEN PERMISSION OF NYSTROM IS PROHIBITED.