

9300 73rd Ave N.  
Brooklyn Park, MN 55428

Toll-Free: 800-547-2635  
Fax 800-317-8770



Right to site.

Direct Phone: 763-488-9200  
Direct Fax: 763-488-9201

e-mail: [info@nystrom.com](mailto:info@nystrom.com)  
Internet: [www.nystrom.com](http://www.nystrom.com)

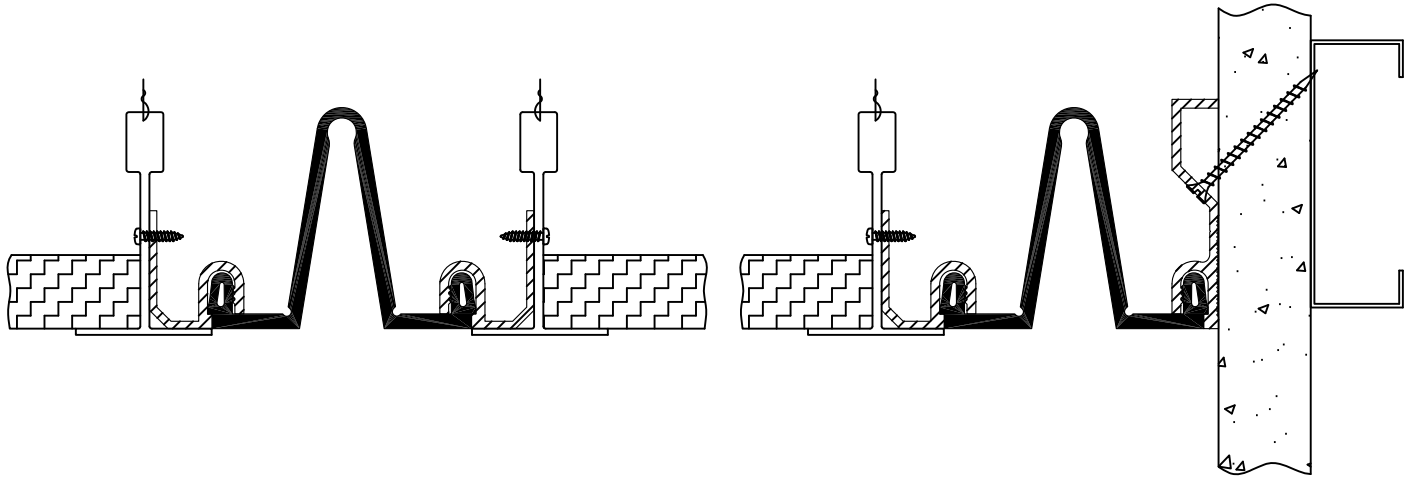

Seal Wall – Standard Series  
Model(s) "EJ-LCE-200/300/400/500/600" &  
"EJ-LCE-200W/300W/400W/500W/600W"  
Vertical Expansion Control Systems

The following installation procedure is very important and must be fully understood prior to beginning any work. To ensure proper installation and performance of expansion joint system the following actions must be completed by the installing contractor. Failure to do so will affect product warranty.

- 1) Carefully read and understand installation procedure. Contact Technical Service Department for product assistance.
- 2) Inspect all shipments and materials for missing or damaged components and hardware. Contact Customer Service with order number and invoice for prompt assistance.
- 3) Inspect substrate or adjacent construction for acceptance before beginning work. Report unacceptable construction to the project manager for scheduled repair work.

PN: 28050A

# Standard Components

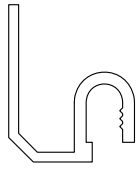

Ceiling Extrusion  
Part Number-27426

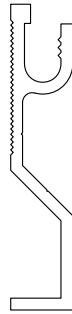

Corner Wall Extrusion  
Part Number-27427



\*\*SI 750 Adhesive  
Part Number - 27514

\*\*Optional components for splice procedures. Place order for required quantities.

Components shown below vary in size depending on model of system



EJ-LCE-200/200W

Model	Seal Part Number			
	Black Seal	White Seal	Grey Seal	Beige Seal
EJ-LCE-200/200W	28009	28010	28011	28012
EJ-LCE-300/300W	28013	28014	28015	28016
EJ-LCE-400/400W	28017	28018	28019	28020
EJ-LCE-500/500W	28021	28022	28023	28024
EJ-LCE-600/600W	28025	28026	28027	28028



EJ-LCE-300/300W

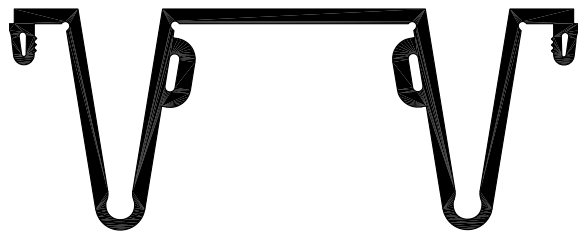

EJ-LCE-400/400W  
EJ-LCE-500/500W

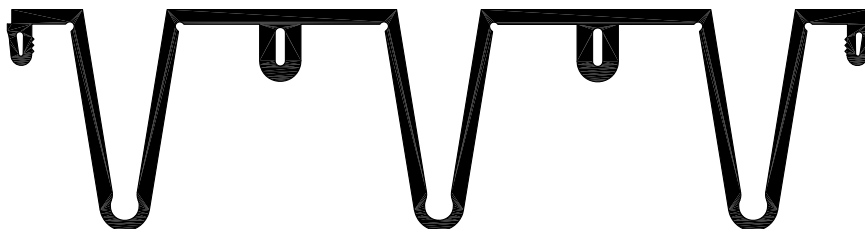

EJ-LCE-600/600W

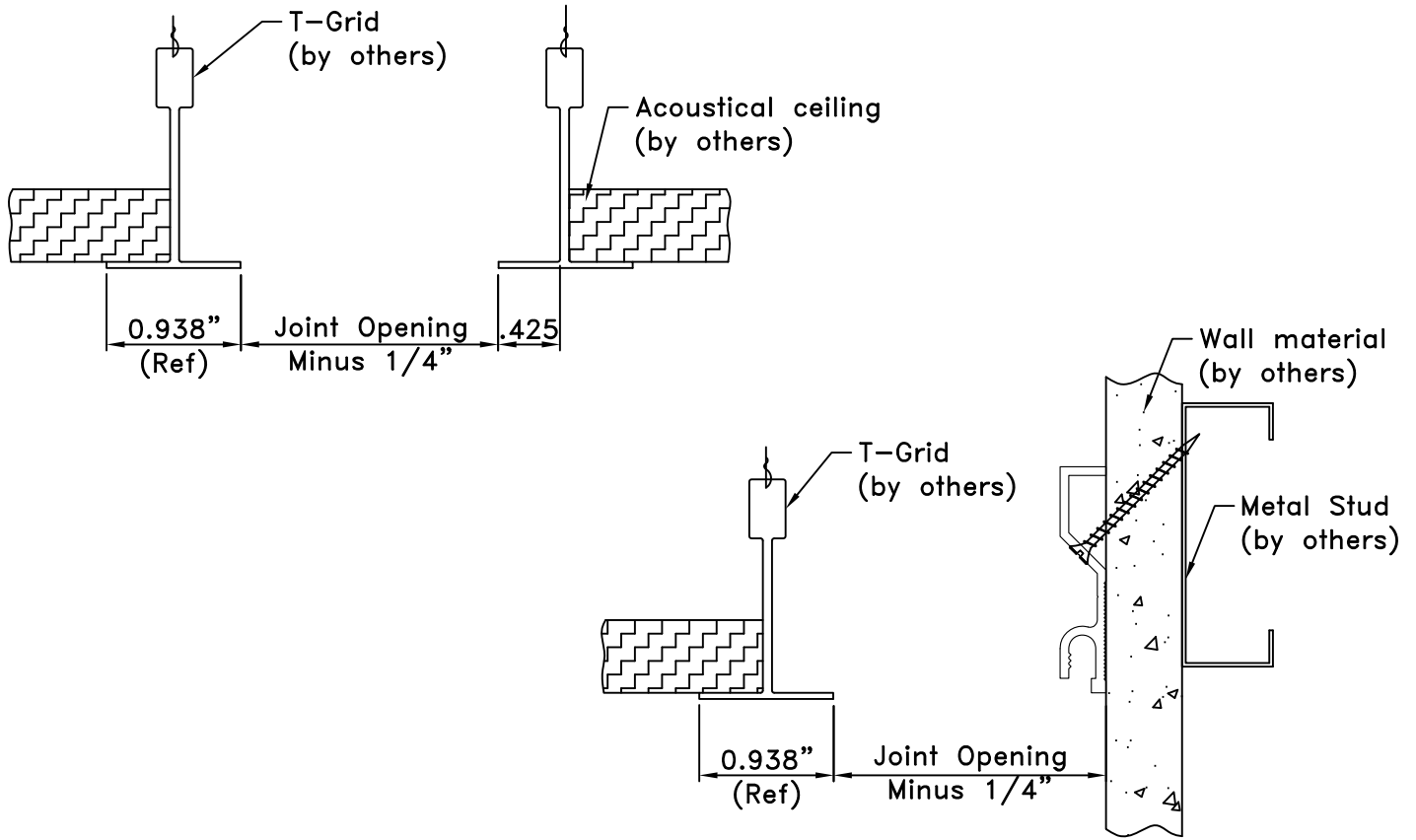

1

Prior to beginning work, installer shall inspect for proper ceiling construction. Verify joint opening to match expansion control system requirements.

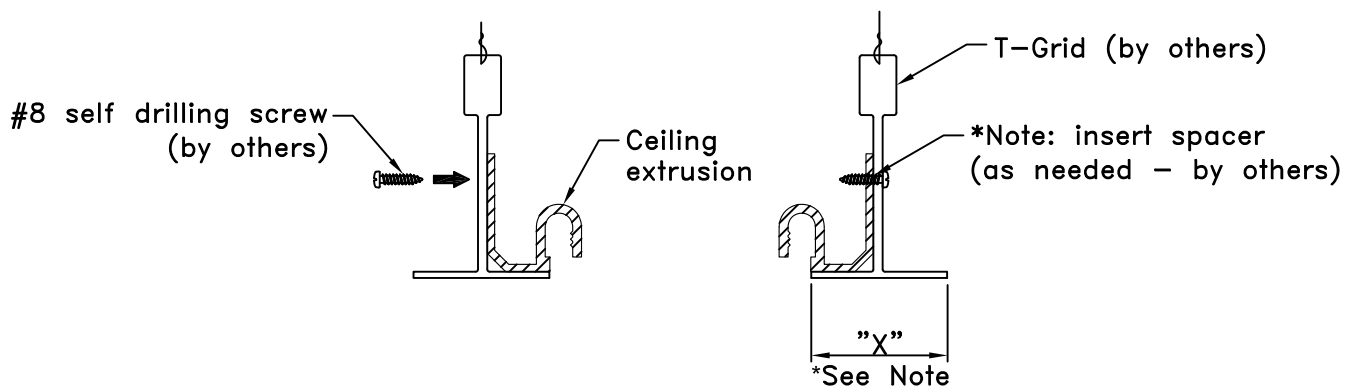

2

Prior to fastening the ceiling extrusion to the "T" grid, remove ceiling tiles on both sides of the joint location. Once ceiling tiles have been removed, the contractor can fasten the aluminum extrusion to the "T" grid using at least #8 self drilling screws (by others) space at 24" O.C.

Note: If dim "X" is greater than .938" insert spacer between "T" and aluminum extrusion as indicated in view above.

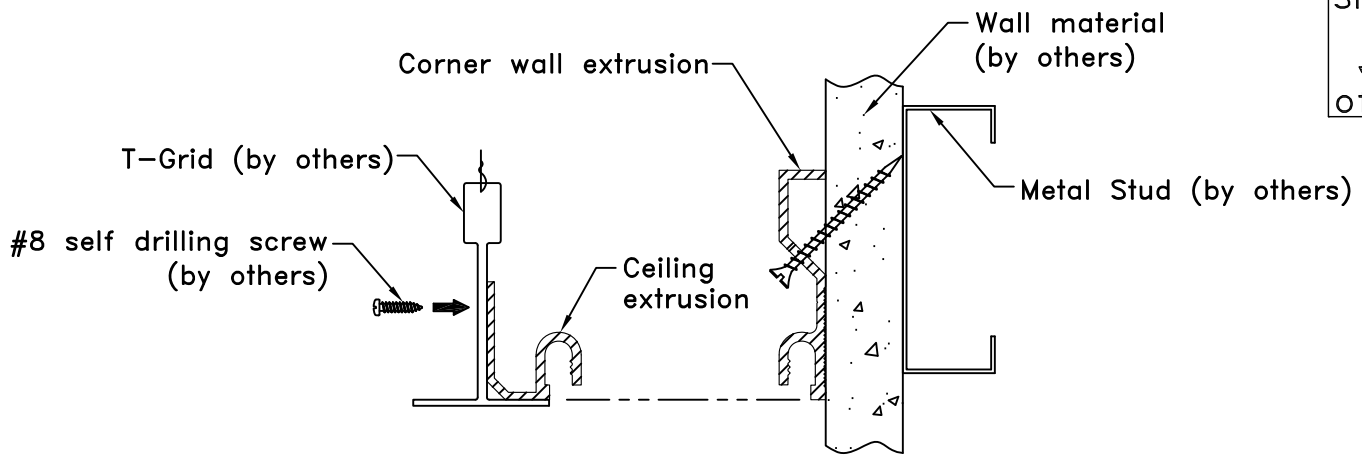

**2A** Place aluminum corner wall extrusion on edge of opening as shown. Drill through extrusion, drywall and into stud. Fasten with drywall screws (by others) spaced at 24" O.C. max, starting 6" from ends. Prior to fastening the ceiling extrusion to the "T" grid, remove ceiling tiles on both sides of the joint location. Once ceiling tiles have been removed, the contractor can fasten the aluminum extrusion to the "T" grid using at least #8 self drilling screws (by others) space at 24" O.C.

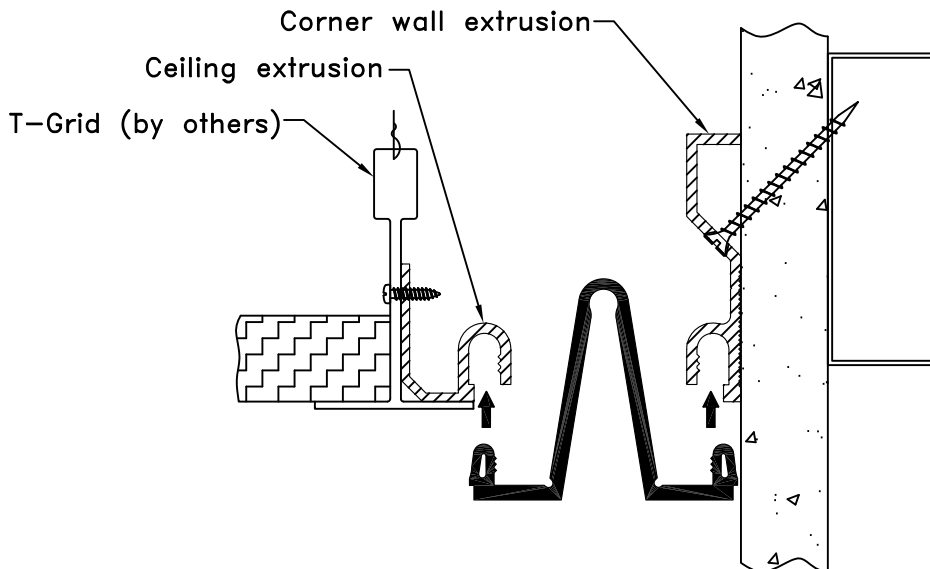
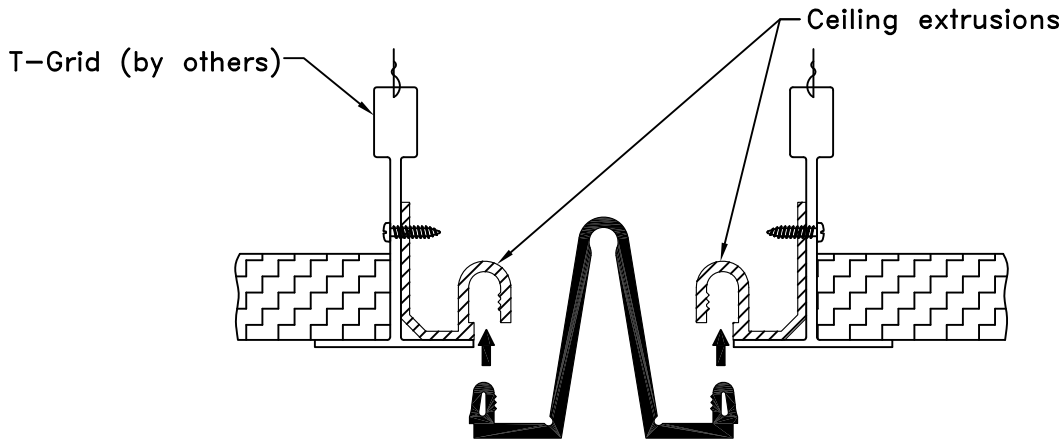

**3** Squeeze or slide elastomeric seal into the cavities of the aluminum extrusion.

## Suggested Field Splice Procedure

1. Cut ends of seal with a sharp knife and miter box to the desired angle. Insure that cuts are clean and straight.
2. Clean ends of seal with a solvent.
3. Apply SI 750 Adhesive to one of the two seal ends to be bonded.
4. Apply pressure bringing the two surfaces into tight contact immediately after adhesive is applied. Hold in place for one to two minutes for initial bond.
5. Re-Check quality of all splices/miters and apply adhesive as required.
7. It is usually recommended to allow 15 minutes prior to installing seal. To achieve proper working strength care shall be exercised as a result that it takes 24 hours for adhesive to fully cure.

