

MIAMI-DADE COUNTY
APPROVED

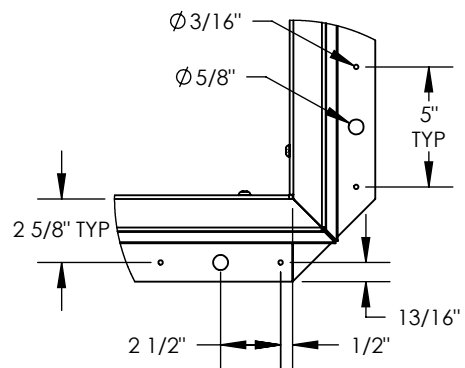

DETAIL C
SCALE 1 : 8

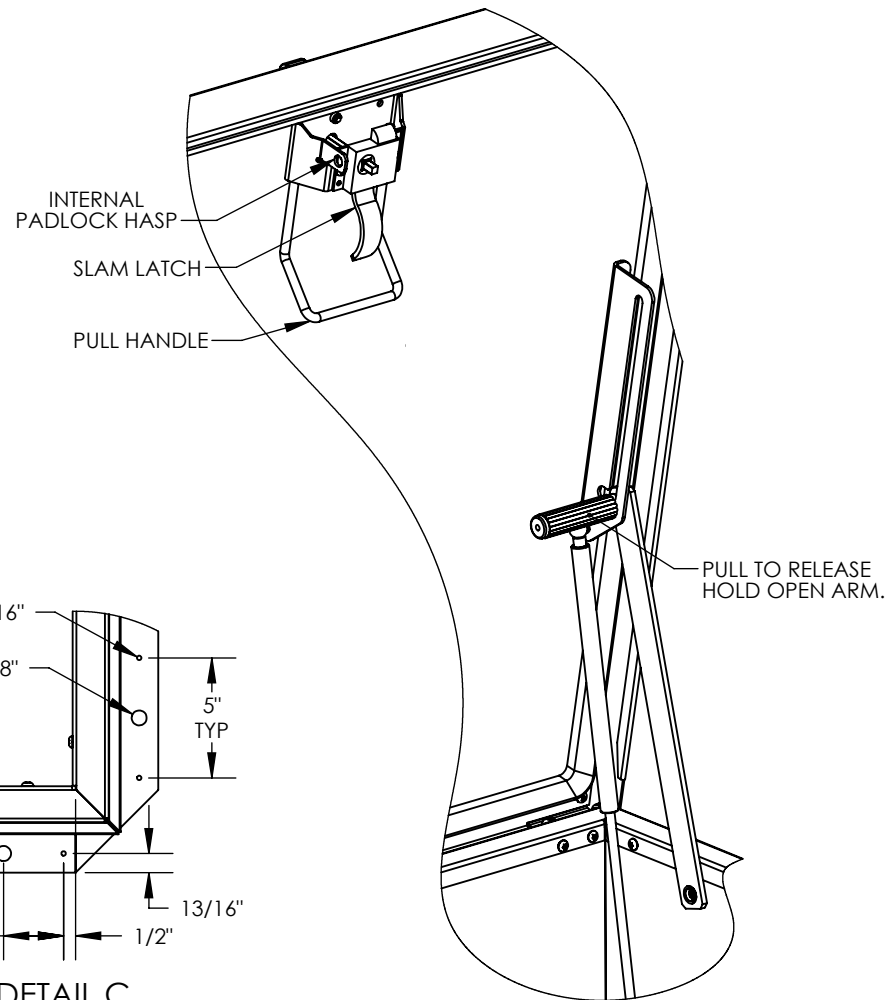
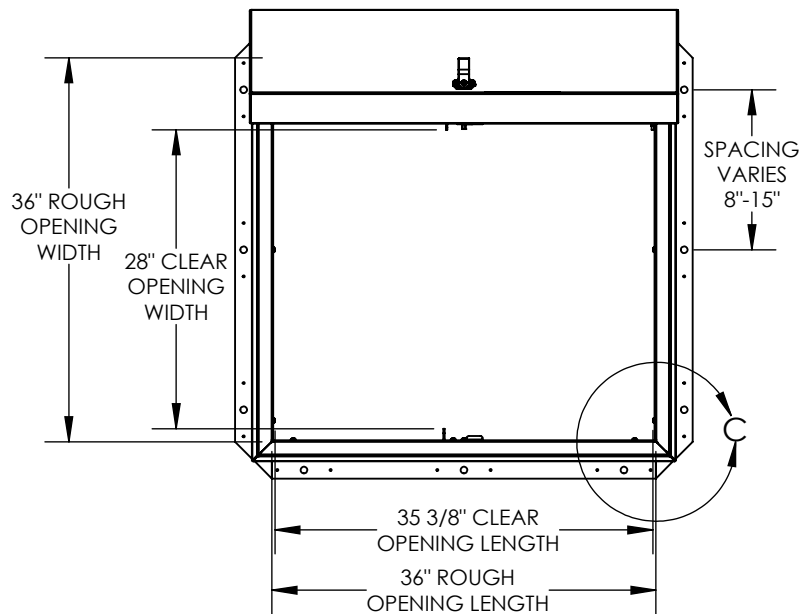
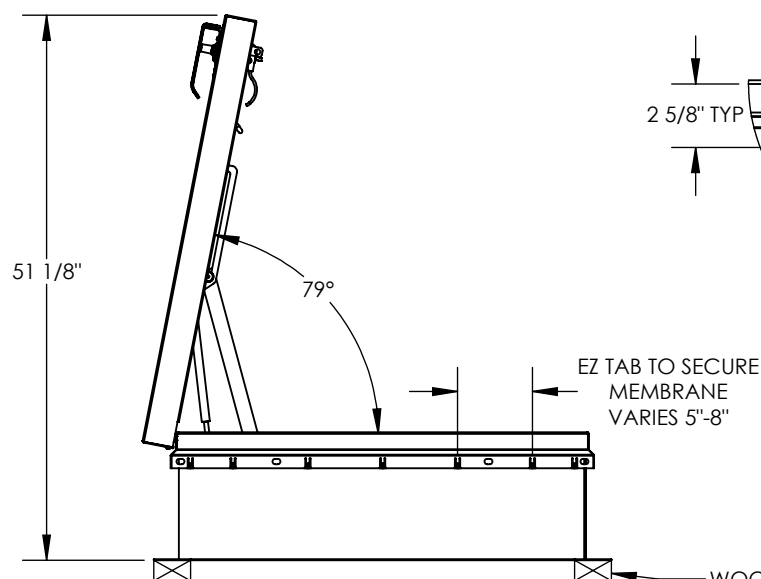

WOOD, CONCRETE, OTHER MATERIAL FOR MOUNTING BY OTHERS (NIC)

			TITLE: Roof Hatch, Hurricane 36x36, Sngl Dr, Galv, Gray Pwd, Sngl Wall Curb		
9300 73rd Avenue North, Minneapolis, MN 55428			SIZE: A	DWG. NO.: RHHG36X36S1T	REV: -
DRAWN: SGS	DATE: 04/01/15	RELEASED: IMT	WEIGHT: 170.3 lbs	SHEET 2 OF 2	

PROPRIETARY AND CONFIDENTIAL: THE INFORMATION CONTAINED IN THIS DRAWING IS THE SOLE PROPERTY OF NYSTROM. ANY REPRODUCTION IN PART OR AS A WHOLE WITHOUT THE WRITTEN PERMISSION OF NYSTROM IS PROHIBITED.