



Vinyl Wall Covering

Model(s): WCV-P

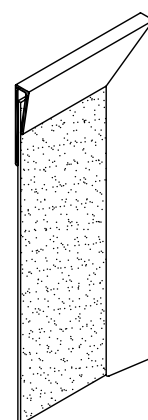
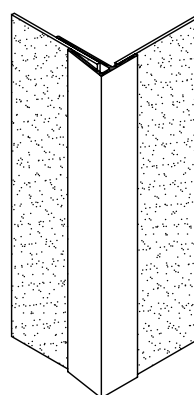
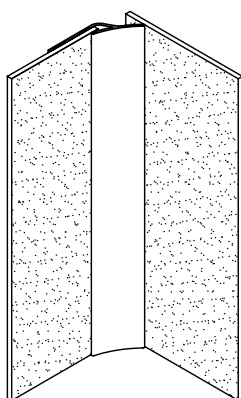
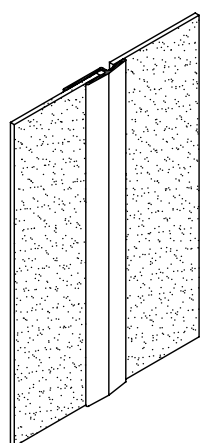
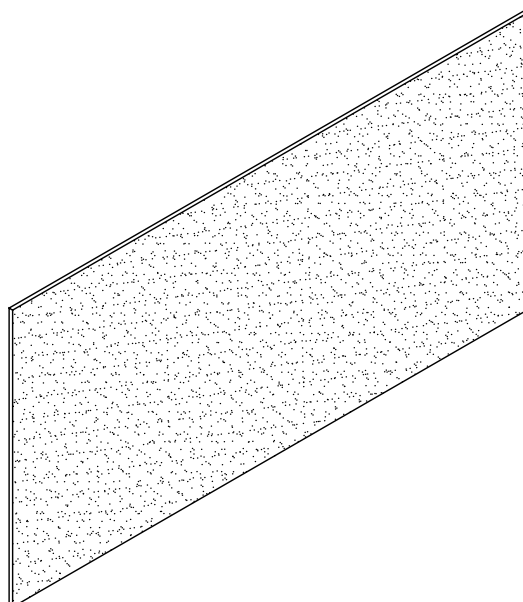

Table of Contents

General Description.....2
 Installation.....4-10
 Maintenance.....11
 Parts List.....12
 Standard Warranty.....13
 Factory Assistance.....14

Copyright

2016 by Nystrom, Inc. All rights reserved.

This document contains proprietary information. No part of this document may be reproduced without the prior written consent of Nystrom, Inc.

Note

The information in this document is subject to change without notice.

General Safety Precautions

Improper selection, installation, or use can cause personal injury or property damage. It is solely the responsibility of the user, through its own analysis to select products suitable for their specific application requirements, ensure they are properly maintained, and limit their use to its intended purpose.

Follow proper local, state and federal regulations for proper installation and operation requirements.

GENERAL DESCRIPTION

Vinyl Wall protection is designed for years of safe building use. Proper installation of the wall protection is critical to the product's performance. The following are general instructions for installing, maintaining and cleaning vinyl wall protection. These are recommended general guidelines only. Locally accepted installation practices and procedures should be followed to ensure a system that meets all local code requirements.

INSTALLATION

Preparation: Verify that all products listed on the packaging slip are included in the package. Check the products for damage. If product is damaged, contact customer support immediately to report a freight claim.

IMPORTANT: Vinyl wall covering is a non-reinforced, semi-rigid, thermoplastic product that may be subject to dimensional changes (i.e. expansion or contraction) with temperature fluctuations. There is a tolerance of 1/32 inch per foot on diagonal for all sheet sizes. Follow these recommendations precisely for best results.

Wall protection sheets must be stored flat in the original packaging. Do not stand sheets on end or store other material on top of them. Rolls must be stored in the original packaging; do not stack rolls or store other material on top of rolls. Store in a clean dry place where the temperature is maintained above 50°F (10°C).

Before Installation

The temperature of the walls and rooms should be maintained at a minimum of 70° F (21° C) for at least 48 hours prior to installation. Allow wall covering and all adhesives to acclimate for at least 24 hours at a minimum temperature of 70° F (21° C) but no more than 80° F (27° C) before beginning the installation process. Place wall covering sheets on a clean, flat surface and weight the corners for at least 24 hours to reduce the possibility of curl and to relax the vinyl. Unroll wall covering rolls and allow to lie flat for at least 24 hours. Wipe the back of the vinyl with a damp rag to remove any dust and allow to dry thoroughly.

During Installation

Maintain a constant temperature and environment while installing. Temperature for the application surface and the room should be maintained at a minimum of 70°F (21°C) and a maximum of 80°F (27°C), with the preferred temperature being 75°F (24°C) during installation. If relative humidity is greater than 80%, do not install wall covering because high humidity can significantly lengthen the curing time of adhesives. Don't install wall covering near heating vents, radiators, etc. or in direct sunlight; resulting expansion and contraction can cause distortion, blistering, etc.

Cutting Wall covering

Thinner gages (.030 inches and .040 inches) can be cut with a utility knife. Use a metal straight edge as a guide and make several passes with the knife blade along the line to be cut. Thicker gages (0.60 inches and above) can be cut by scribing with a Plexiglass acrylic sheet cutting tool and breaking. Use a metal straight edge as a guide and make several passes with the cutting tool along the line to be cut. For best results place the scribed edge over a 3/4 inch diameter dowel and apply downward hand pressure on both sides of the scribed line.

INSTALLATION

Wall covering can also be cut using most common types of power sawing equipment, including circular saws, jigsaws, and saber saws. Circular saws are used for straight cuts; jib and saber saws are used for cutting small radii curves. Use standard blades designed for cutting plywood; these are preferred over carbide-tipped blades when cutting thin gages of wall covering.

Drilling Wall covering

Holes may be drilled in vinyl wall covering with standard, high speed drills operated over a wide range of speeds as long as feeds are not forced. Use of a broad point wood bit will produce the cleanest shaped hole.

Routing Wall covering

Portable routers may be used for cutting vinyl to size. Usually a wood jig is constructed on site into which the vinyl wall covering is placed, measured, marked, and cut using the portable router.

After Installation

Don't expose walls to elevated temperatures or direct sunlight as this can result in wall surface temperatures in excess of 100°F (38°C) which can cause blistering and distortion of wall covering. Maintain temperature stability between 70°F (31°C) and 80°F (27°C) for 24 to 48 hours after installation.

Tools and Adhesives

- To ensure proper installation, make sure that you choose the appropriate tools and adhesive for your surface conditions.
- Be sure to follow manufacturer's instructions for proper adhesive use and application, including all storage and temperature recommendations. Manufacturer recommends using either mastic adhesive or 3M Fastbond 30 contact adhesive, or an exact equivalent of one of these products.
- Maintain adequate ventilation when working with adhesives and/or cleaning products.
- Keep tools clean and in good working condition at all times.

INSTALLATION

Mastic Adhesive - Ready to bond after 30-45 minutes on porous substrates; on non-porous substrates 60 minutes or until most of the color changes to clear.

Contact Adhesive - Bonds surfaces instantly.

Tools - Smooth Surface

- MASTIC ADHESIVE**
- Notched trowel - use 1/16 inch square notch for wall covering less than .040 inches thick or 1/8 inch V-notch trowel (1/2 inch spacing) for wall covering .040 inch and thicker
- Mastic adhesive
- Mason's stone for rough surfaces

- CONTACT ADHESIVE**
- Short nap paint roller and tray
- Trim brush
- 3M Fastbond 30 contact adhesive or equivalent
- Polyethylene (4-8 mil) Kraft paper or scrap vinyl wall covering to act as slip sheeting (place between wall covering and contact adhesive as you position sheet above adhesive; pull out as you place sheet on adhesive)
- Stiff paperhanger brush

- Chalk line/plumb bob
- Block plane, sanding block or scraper
- Heavy-duty razor knife for thin gage vinyl or Plexiglass acrylic sheet cutter for .060 inch gage and above
- Straight edge
- 3/4 inch dowel (for breaking score lines)
- Saber saw
- Hand-held circular saw
- 1 inch putty knife
- Heavy-duty pressure roller, such as a Crain #333 extension roller or equivalent

INSTALLATION

Surface Preparation

1. Remove any pre-existing wall covering. For best results walls must be resurfaced if damaged. Make certain that porous substrates (i.e. concrete block) are painted or sealed properly and are dry to the touch.
2. Remove any rough spots by sanding walls until smooth.
3. Test for paint adhesion. Use a razor to score the surface of a 12 inch square area in a grid pattern. Try to remove the broken paint film by applying cellophane or masking tape; pull off sharply. If the paint comes off, the wall must be stripped prior to installation.
4. Prime unfinished surfaces with a latex flat primer.

Before applying adhesive, the walls and wall covering sheets must be completely free of grease, dirt, etc. Wipe surfaces with a clean water-dampened rag to remove any dirt or debris.

Dry Fitting Sheets

1. Use a chalk line or masking tape to outline the area to be covered. If installing as wainscoting, make sure the sight line at the top edge is level. On full wall installation the vertical edge must be plumb.
2. For consistent appearance, install sheets with the “Windrift” texture running in the same direction. This is indicated by arrows printed on the back side of each sheet.
3. Wall covering must have 1/16 inch (1.6mm) expansion gap between the sheets.
4. Do not butt wall covering up against door jambs, ceilings, or baseboards. Leave a 1/16 inch (1.6mm) expansion clearance.
5. For recommendations on installing joint cover, inside and/or outside corner, or top cap moldings, etc., see fig. .
6. An expansion clearance of at least 1/8 inch (3.2mm) must be allowed on all four sides of the sheets on interior surfaces of perimeter walls and any area subject to temperature variations to permit natural dimensional change.
7. When installing fixtures such as handrails, air ducts, etc., oversized holes must be drilled due to the natural expansion and contraction of the sheet as temperature changes occur. Accessories such as caulk or moldings can be used to minimize the visual effect of large openings.
8. Check the surface that the wall covering will be applied to for squareness. Check all wall covering sheets for squareness; there is a tolerance of 1/32 inch per foot on diagonal on all sheets.

MASTIC ADHESIVE INSTALLATION

Applying Mastic Adhesive

1. Be certain that the entire substrate, including all drywall and drywall taping compound, is sealed before applying mastic adhesive. Newly sealed walls must dry completely prior to application of mastic adhesive.
2. Follow all of the adhesive manufacturer's recommended safety precautions, such as providing adequate ventilation, etc.
3. Apply mastic adhesive only to the wall surfaces. Don't apply adhesive to the wall covering. Don't let adhesive dry on tools or materials; keep trowel grooves clean while working by washing frequently.

Spread the adhesive evenly onto the walls with a notched trowel only, making sure to cover the surface area completely. To adhere .030 inch gage wall covering to smooth walls use a 1/16 inch square-notched trowel to apply adhesive. For all other gages of wall covering, use a 1/8 inch deep V-notched trowel. Make sure you achieve 100% surface coverage on all walls with an even coat; using an insufficient amount of adhesive is the cause of most installation problems.

4. Allow mastic approximately 30-45 minutes to dry before installing wall covering on porous substrates. The adhesive should start to become firm to the touch; this increases the initial tack and helps reduce telegraphing of bulges.

For non-porous substrates such as painted metal, stainless steel, etc., let mastic dry for a minimum of one hour but not longer than three hours. The change in color of the adhesive from white to clear signifies the optimum time for adhering the wall covering.

Installing Sheets

1. Align the edge of the vinyl wall covering sheet with a chalk or tape line. (It is recommended that roll material be cut into 12 feet long sheets maximum for .030 inch gage and 10 foot long maximum for .040 inch gage to avoid excess twisting and additional thermal expansion/contraction problems.) Lay all cut sheets flat and weight the corners for at least 24 hours prior to installation.
2. Place the sheet on the wall and smooth it into place by hand. DO NOT allow vinyl wall covering sheet to touch adhesive unless it is completely aligned or the installer may be unable to re-adjust the sheets properly.
3. Immediately roll the entire surface of the sheet with a heavy-duty pressure roller, such as a Crain #333 extension roller or the equivalent. Begin rolling in the center of the sheet and work outwards to the edges. THE INSTALLER MUST APPLY HEAVY PRESSURE WHILE ROLLING TO PREVENT ANY AIR POCKETS FROM FORMING UNDER THE SURFACE. Roll sheets completely out to all of the edges.
4. During and after installation, remove any excess adhesive on the front of vinyl wall covering sheets immediately. FOLLOW THE DIRECTIONS FROM THE ADHESIVE MANUFACTURER FOR REMOVING EXCESS ADHESIVE. Do not allow adhesive to dry on surface of wall covering or tools. Use clean rags to avoid redepositing adhesive residue on wall covering. Dry adhesives can sometimes be removed with naphtha or mineral spirits. For additional cleaning recommendations, see page 11.

CONTACT ADHESIVE INSTALLATION

Applying Contact Adhesive

1. Be certain that substrate is painted or sealed using latex primer before applying contact adhesive. Newly sealed walls must be completely dry prior to application of contact adhesive.
2. Follow all of the adhesive manufacturer's recommended safety precautions, such as providing adequate ventilation, etc.
3. Stir adhesive thoroughly before beginning.
4. Apply two coats of contact adhesive to the wall using a short nap roller; allow the first coat to dry completely before applying the second coat. Use a trim brush to cut in any corners.

Apply one coat of adhesive to the back (smooth) side of the sheet of wall covering using a short nap roller.

To ensure evenness in the adhesive film, avoid excessive rolling or re-rolling. Avoid puddles or dry spots.

5. Wait for 2-1/2 to 3 hours. After adhesive dries, 3 hours remain to complete the bonding. THE LONGER YOU WAIT (UP TO 4 HOURS TOTAL) THE STRONGER THE INITIAL BOND WILL BE. The adhesive color darkens as it becomes dry. Do not install wall covering until all wet spots have disappeared. You must re-coat the wall covering and the walls with adhesive if sheet is not installed within 4 hours.
6. Dry adhesive should have a glossy film. Dull spots after drying indicate insufficient adhesive; these spots must be re-coated.
7. Because contact adhesive will bond to itself immediately upon contact, use of slip sheet is strongly recommended to prevent accidental bonding.

Installing Sheets

1. Align the edge of the vinyl wall covering sheet with a chalk or tape line. (It is recommended that roll material be cut into 12 feet long sheets maximum for .030 inch gage and 10 foot long maximum for .040 inch gage to avoid excess twisting and additional thermal expansion/contraction problems.) Lay all cut sheets flat and weight the corners for at least 24 hours prior to installation.
2. Carefully remove the slip sheet while smoothing the wall covering sheet into place using a stiff paperhanger brush.
3. Immediately roll the entire surface of the sheet with a heavy-duty pressure roller, such as a Crain #333 extension roller or the equivalent. Begin rolling in the center of the sheet and work outwards to the edges. THE INSTALLER MUST APPLY HEAVY PRESSURE WHILE ROLLING TO PREVENT ANY AIR POCKETS FROM FORMING UNDER THE SURFACE. Roll sheets completely out to all of the edges.
4. During and after installation, remove any excess adhesive on the front of vinyl wall covering sheets immediately. FOLLOW THE DIRECTIONS FROM THE ADHESIVE MANUFACTURER FOR REMOVING EXCESS ADHESIVE. Do not allow adhesive to dry on surface of wall covering or tools. Use clean rags to avoid redepositing adhesive residue on wall covering. A solvent such as naphtha or mineral spirits may be used. For additional cleaning recommendations, see page 11.

ACCESSORY MOLDING INSTALLATION

- The temperature of the walls and rooms should be maintained at a minimum of 70°F (21°C) and a maximum of 80°F (27°C) for proper installation.
- Cut moldings with a common power saw with standard blades designed for cutting plywood, or use carbide tipped blades. When planning the job, leave allowances for intersecting moldings (for example, where a top cap molding meets a joint cover).
- Using Mastic Adhesive: You don't need to apply additional adhesive to the back side of the moldings; the adhesive troweled onto the wall is sufficient.
- Using Contact Adhesive: Use a small trim brush and apply one coat of contact adhesive to the back side of moldings and allow to dry according to manufacturer's instructions. Do not allow adhesive to contact visible surface of moldings.

Top Cap

Slip the top cap molding over the edge of the vinyl wall covering prior to using the high-pressure roller. The molding is trapped between the wall covering and the substrate. Immediately after installing the top cap molding use the high-pressure roller to roll all surfaces and edges of wall covering.

Inside Corner

After the first sheet of wall covering has been installed, leave a 1/16 inch gap at the interior corner. Put the channel of the inside corner onto one side of the sheet being installed on the intersecting wall and install this sheet with the corner molding overlapping the previously installed sheet. Leave a 1/16 inch gap within the molding to allow for sheet expansion.

Outside Corner

After the first sheet of wall covering has been installed put the channel of the outside corner onto one side of the sheet being installed on the intersecting wall and install this sheet with the molding overlapping the previously installed sheet. Leave a 1/16 inch gap within the molding to allow for sheet expansion.

Joint Cover

After the first sheet of wall covering has been installed put the channel of the joint cover onto one side of the sheet being installed on the intersecting wall and install the second sheet next to the first sheet with the free leg of the joint cover overlapping the previously installed sheet. Leave a 1/16 inch gap within the molding to allow for sheet expansion. Install successive sheets in similar manner.

Caulk

Caulk is an acrylic based evaporative cure sealant with a special silicone modifier that is color matched to our vinyl wall covering. Caulk provides a waterproof seam when applied properly. Caulk allows for the normal thermal expansion of wall covering. It will darken to color match as it dries. Tooling is recommended to ensure positive contact with joint surfaces. A 10.5 oz. tube covers approximately 150 linear feet. Joint dimensions should not exceed 3/8 inch by 3/8 inch. Remove unwanted caulk immediately from wall covering surfaces and tools with soapy water.

MAINTENANCE

ALWAYS FOLLOW THE DIRECTIONS FROM THE ADHESIVE MANUFACTURER TO CLEAN UP AND/OR REMOVE EXCESS ADHESIVE. To prevent possible staining of wall covering, it's important to remove any adhesive residue and/or other dirt immediately upon completion of installation of sheets. Use mineral spirits, naphtha, or a specific solvent recommended by the adhesive manufacturer and follow the directions carefully. Rinse the cleaned area immediately with warm soapy water, then rinse with clean water and dry with a soft cloth.

- Do not use ammonia based cleaner, powdered cleaners or bleach; they can leave a residue if not rinsed properly. Use a liquid cleaner, such as SoftScrub without bleach, Fantastic, 409, etc., on a sponge or a soft cloth; use a stiff bristle brush to remove heavy dirt from the textured surface if necessary. Always rinse with clean water and dry with a soft cloth.
- For heavy-duty cleaning (graffiti, etc.) use a stronger cleaning agent, such as “Crown Anti-Vandal Spray”, or the equivalent. Follow the same procedures noted above, always rinsing all areas thoroughly in clean water and drying completely.
- High-pressure water can also be used to clean wall covering surface. Make sure that all seams and joints are completely sealed and do not spray high-pressure water directly on caulked seams or joints. Do not use water with extremely high temperature and do not use steam to clean vinyl because it may cause blistering and/or warping.
- Do not use abrasive cleaners or other cleaning implements, such as steel wool or cleaning pads, as they may mark or gouge the material.
- To add luster and additional protection, you can apply a thin layer of a vinyl enhancer, such as Pledge.
- Please contact manufacturer for technical support questions and/or replacement parts.

PARTS LIST

| Part Number | Description |
|-------------|---------------------------------------|
| MOLDING | |
| MOC1 | OUTSIDE CORNER |
| MIC1 | INSIDE CORNER |
| MJM1 | TOP CAP / J-MOLDING |
| MDB1 | .030 - .060 JOINT COVER / DIVIDER BAR |
| ACCESSORIES | |
| CMC | COLOR MATCH CAULK |
| HROLLER | HEAVY PRESSURE ROLLER |
| ADHESIVES | |
| ADF1 | 3M FASTBOND CONTACT CEMENT (1 GAL) |
| ADF5 | 3M FASTBOND CONTACT CEMENT (5 GAL) |
| ADM1 | SUPER TEK XT-2000 MASTIC (1 GAL) |
| ADM5 | SUPER TEK XT-2000 MASTIC (5 GAL) |

When ordering, please specify color name. Current color charts are available on www.Nystrom.com.

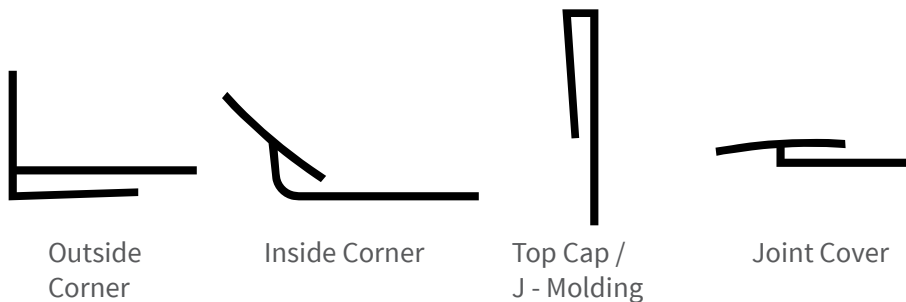

STANDARD WARRANTY

Nystrom warrants all Wall and Door Protection to be free from manufacturing defects in materials, factory finishes and workmanship for a period of five (5) years from the date of shipment. Should a product fail to function in normal use within this period, Nystrom shall furnish a replacement or new part at Nystrom's discretion. Failure to use product in methods consistent with Nystrom product manuals shall relieve Nystrom of any liability. Our liability under this warranty excludes installation or removal costs involved in the product replacement and excludes any responsibility for incidental or consequential damage of any nature.

For warranty support and registration please visit
www.nystrom.com/support

FACTORY ASSISTANCE

Nystrom engineers and manufactures Wall and Door Protection for worldwide customers. Our products are an integral part of commercial projects to prevent damage and safeguard your building investment. Recognized as an industry leader, Nystrom has been relied upon by building and construction professions for over 50 years and we pride ourselves in offering exceptional technical support.

Please do not return any product before discussing your application problem with a Nystrom representative and obtaining a Return Authorization.

Your Nystrom representative is eager to help you. Please feel free to call your representative or contact Nystrom to discuss your application.

Nystrom
9300 73rd Avenue North
Minneapolis, MN 55428

Phone: 800.547.2635
Fax: 800.317.8770
Email: info@nystrom.com

Visit www.nystrom.com for the latest version of this document and more information.



9300 73rd Avenue North
Minneapolis, MN 55428

Phone (800) 547-2635
Fax (800) 317-8770

