

Seismic Aluminum Infill Flooring System

**NO BUMP APPLICATION
(SFP with Infill/SFPw with Infill)**

BENEFITS

SEISMIC TECHNOLOGY The cover plate stays centered over openings before, during and after a seismic event with the use of the centering bar.

ADA COMPLIANT Heavy pedestrian traffic requirements are met while maintaining a smooth transition, limited sight-line, and no bump transition.

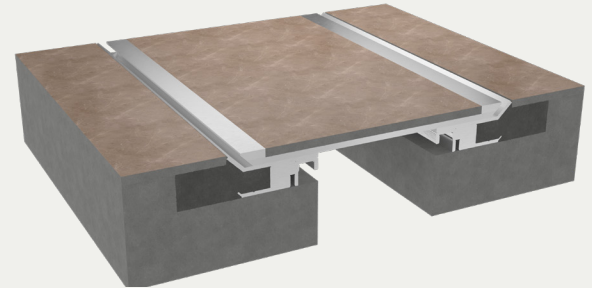

DETAILS

MATERIAL

6063-T5 Aluminum, Meets ASTM B221
6061-T6 Aluminum, Meets ASTM B209
5052 H32 Aluminum, Meets ASTM B209

FINISH Mill

INFILL DEPTH 1/8", 1/4" and 3/8"

MOVEMENT

Thermal: Horizontal and Vertical
Seismic: Lateral Shear

MOUNTING Blockout

JOINT SIZE 2 inches to 12 inches

LENGTH 10 Linear Feet

APPLICATION Interior

LOAD Pedestrian and Light Cart

INSTALLATION Floor

OPTIONS Moisture barrier, Fire barrier, Additional Materials, Sizes and Finishes available upon request

INSTALLATION

FLOOR-TO-FLOOR

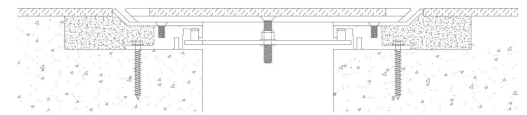

FLOOR-TO-WALL/CORNER

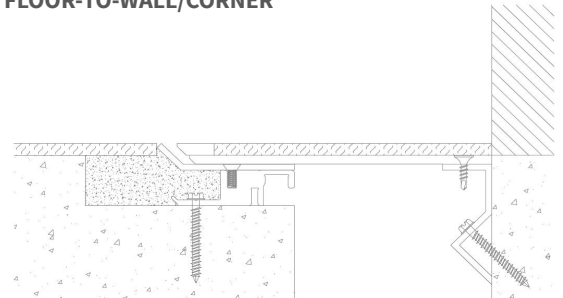

AS BUILT CONDITIONS MAY VARY. For more information, download our Installation and Operation Manuals (IOM) and Shop Drawings on nystrom.com

ORDER GUIDE

MODEL	APPLICATION	JOINT SIZE AT MEAN T°F	SYSTEM WIDTH	INFILL HEIGHT	TOTAL MOVEMENT
EJN-SFP-200-125, -250, OR -375	Floor to Floor	2" (51mm)	Varies, See Shop Drawing	.125" (3mm), .250" (6mm), or .375" (10mm)	2" (51mm)
EJN-SFP-400-125, -250, OR -375	Floor to Floor	4" (102mm)	Varies, See Shop Drawing	.125" (3mm), .250" (6mm), or .375" (10mm)	4" (102mm)
EJN-SFP-600-125, -250, OR -375	Floor to Floor	6" (152mm)	Varies, See Shop Drawing	.125" (3mm), .250" (6mm), or .375" (10mm)	6" (152mm)
EJN-SFP-800-125, -250, OR -375	Floor to Floor	8" (203mm)	Varies, See Shop Drawing	.125" (3mm), .250" (6mm), or .375" (10mm)	8" (203mm)
EJN-SFP-1000-125, -250, OR -375	Floor to Floor	10" (254mm)	Varies, See Shop Drawing	.125" (3mm), .250" (6mm), or .375" (10mm)	10" (254mm)
EJN-SFP-1200-125, -250, OR -375	Floor to Floor	12" (305mm)	Varies, See Shop Drawing	.125" (3mm), .250" (6mm), or .375" (10mm)	12" (305mm)
EJN-SFP-200W-125, -250, OR -375	Floor to Wall Corner	2" (51mm)	Varies, See Shop Drawing	.125" (3mm), .250" (6mm), or .375" (10mm)	1" (25mm)
EJN-SFP-400W-125, -250, OR -375	Floor to Wall Corner	4" (102mm)	Varies, See Shop Drawing	.125" (3mm), .250" (6mm), or .375" (10mm)	2" (51mm)
EJN-SFP-600W-125, -250, OR -375	Floor to Wall Corner	6" (152mm)	Varies, See Shop Drawing	.125" (3mm), .250" (6mm), or .375" (10mm)	3" (76mm)
EJN-SFP-800W-125, -250, OR -375	Floor to Wall Corner	8" (203mm)	Varies, See Shop Drawing	.125" (3mm), .250" (6mm), or .375" (10mm)	4" (102mm)
EJN-SFP-1000W-125, -250, OR -375	Floor to Wall Corner	10" (254mm)	Varies, See Shop Drawing	.125" (3mm), .250" (6mm), or .375" (10mm)	5" (127mm)
EJN-SFP-1200W-125, -250, OR -375	Floor to Wall Corner	12" (305mm)	Varies, See Shop Drawing	.125" (3mm), .250" (6mm), or .375" (10mm)	6" (152mm)