

Aluminum Hinged Flooring System

SINGLE WING INFILL APPLICATION (FA/FAw)

BENEFITS

- MINIMAL SIGHT LINE** Integrates with floor material and handles substrate offset.
- SURFACE MOUNT** No blockout is required. Simply anchor to subfloor.



DETAILS

- MATERIAL** 6063-T5 Aluminum, Meets ASTM B221
- FINISH** Mill
- MOVEMENT** Thermal: Horizontal and Vertical
- MOUNTING** Surface
- JOINT SIZE** 2 to 3 inches
- LENGTH** 10 Linear Feet
- LOAD** Pedestrian and Light Cart
- INSTALLATION** Floor
- OPTIONS** Moisture barrier, Fire barrier

INSTALLATION

FLOOR-TO-FLOOR

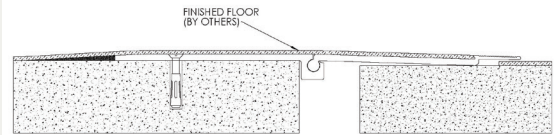

FLOOR-TO-CORNER

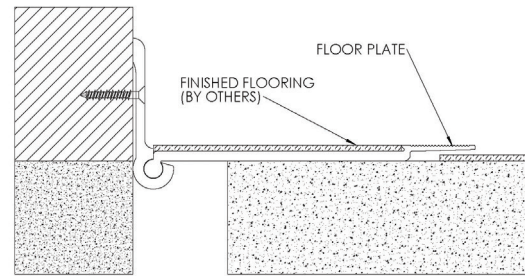

For more information, download our Installation and Operating Manuals (IOM) and Shop Drawings on Nystrom.com

ORDER GUIDE

MODEL	APPLICATION	JOINT SIZE AT MEAN T°F	EXPOSED SIGHT LINE	INFILL HEIGHT	TOTAL MOVEMENT
EJN-FA150-125	Floor to Floor	3" (76mm)	1.5" (38mm)	0.125" (3mm)	1.25" (32mm)
EJN-FA150-250	Floor to Floor	3" (76mm)	1.5" (38mm)	0.25" (6mm)	1.25" (32mm)
EJN-FA150-375	Floor to Floor	3" (76mm)	1.5" (38mm)	0.375" (10mm)	1.25" (32mm)
EJN-FA150-125W	Floor to Wall	3" (76mm)	1.5" (38mm)	0.125" (3mm)	1.25" (32mm)
EJN-FA150-250W	Floor to Wall	3" (76mm)	1.5" (38mm)	0.25" (6mm)	1.25" (32mm)
EJN-FA150-375W	Floor to Wall	3" (76mm)	1.5" (38mm)	0.375" (10mm)	1.25" (32mm)

Additional sizes available, email info@nystrom.com for more information.