

Seismic Elastomeric Corridor Wall & Ceiling System

DRYWALL BEAD APPLICATION (LCD/LCDw)

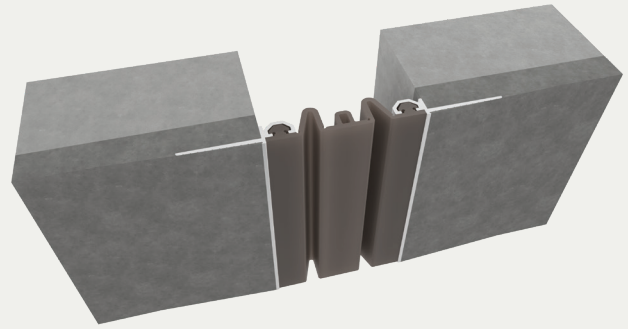

BENEFITS

MAXIMUM MOVEMENT “V” seal design allows for maximum thermal and seismic movement.

DRYWALL BEAD FLANGE Designed for drywall applications with punched holes for easy mounting. Drywall mud is floated overtop of flange and easily painted leaving only the seal exposed.

DETAILS

MATERIAL 6063-T6 Aluminum, Meets ASTM B209

FINISH Mill

MOVEMENT

- Thermal: Horizontal and Vertical
- Seismic: Lateral Shear

MOUNTING Flush with drywall bead

JOINT SIZE 2 to 6 inches

SEAL LENGTH Continuous

APPLICATION Interior

INSTALLATION Wall or Ceiling

OPTIONS Additional size and material options available upon request.

SEAL COLORS



Beige

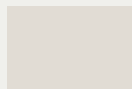

White



Gray



Black

INSTALLATION

WALL/CEILING-TO-WALL/CEILING

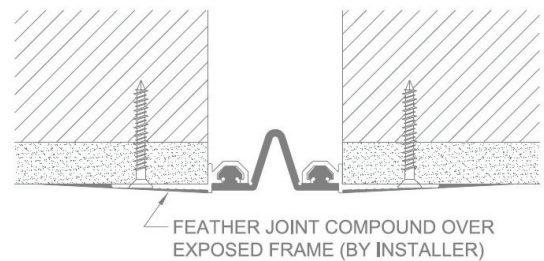

WALL/CEILING-TO-CORNER

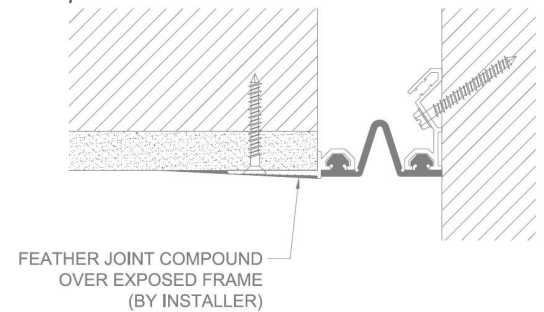

For more information, download our Installation and Operating Manuals (IOM) and Shop Drawings on Nystrom.com

ORDER GUIDE

MODEL	APPLICATION	JOINT SIZE AT MEAN T°F	EXPOSED SIGHT LINE	TOTAL MOVEMENT
EJN-LCD-200	Wall/Ceiling to Wall/Ceiling	2" (51mm)	2" (51mm)	2" (51mm)
EJN-LCD-300	Wall/Ceiling to Wall/Ceiling	3" (76mm)	3" (76mm)	3" (76mm)
EJN-LCD-400	Wall/Ceiling to Wall/Ceiling	4" (102mm)	4" (102mm)	4" (102mm)
EJN-LCD-500	Wall/Ceiling to Wall/Ceiling	5" (127mm)	5" (127mm)	5" (127mm)
EJN-LCD-600	Wall/Ceiling to Wall/Ceiling	6" (152mm)	6" (152mm)	6" (152mm)
EJN-LCD-200W	Wall/Ceiling to Corner	2" (51mm)	2" (51mm)	2" (51mm)
EJN-LCD-300W	Wall/Ceiling to Corner	3" (76mm)	3" (76mm)	3" (76mm)
EJN-LCD-400W	Wall/Ceiling to Corner	4" (102mm)	4" (102mm)	4" (102mm)
EJN-LCD-500W	Wall/Ceiling to Corner	5" (127mm)	5" (127mm)	5" (127mm)
EJN-LCD-600W	Wall/Ceiling to Corner	6" (152mm)	6" (152mm)	6" (152mm)

Additional sizes available, email info@nystrom.com for more information.