

Seismic Aluminum Flooring System

SURFACE BLOCKOUT APPLICATION (SFC/SFCw)



BENEFITS

SEISMIC TECHNOLOGY The cover plate stays centered over openings before, during and after a seismic event with the use of the seismic centering bar.

ADA COMPLIANT Heavy pedestrian traffic requirements are met while maintaining an ADA Compliant transition.

DETAILS

MATERIAL

6063-T5 Aluminum, Meets ASTB B221
6061-T6 Aluminum, Meets ASTM B209
5052 H32 Aluminum, Meets ASTM B209

FINISH Mill

MOVEMENT

- Thermal: Horizontal and vertical
- Seismic: Lateral Shear

MOUNTING Block Out

JOINT SIZE 2-12"

LENGTH 10 Linear Feet

APPLICATION Interior

LOAD Pedestrian and Light Cart

INSTALLATION Floor

OPTIONS Moisture Barrier, Fire Barrier, and Additional Materials, Sizes and Finishes Upon Request

INSTALLATION

FLOOR-TO-FLOOR

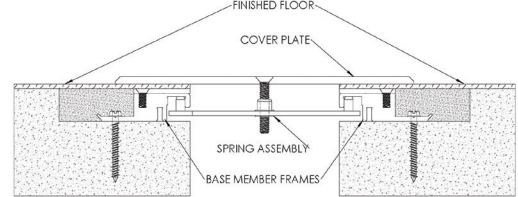

FLOOR-TO-WALL/CORNER

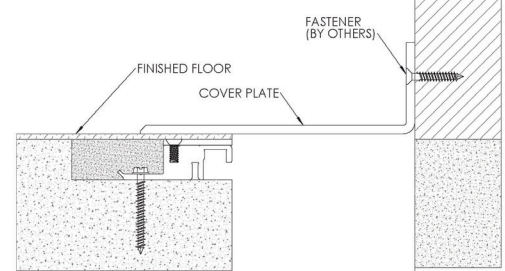

For more information, download our Installation and Operating Manuals (IOM) and Shop Drawings on Nystrom.com

ORDER GUIDE

MODEL	APPLICATION	JOINT SIZE AT MEAN T°F	EXPOSED SIGHT LINE	TOTAL MOVEMENT
EJN-SFC-200	Floor to Floor	2" (51mm)	5" (127mm)	2" (51mm)
EJN-SFC-400	Floor to Floor	4" (102mm)	8" (203mm)	4" (102mm)
EJN-SFC-600	Floor to Floor	6" (152mm)	11" (279mm)	6" (152mm)
EJN-SFC-800	Floor to Floor	8" (203mm)	14" (356mm)	8" (203mm)
EJN-SFC-1000	Floor to Floor	10" (254mm)	17" (432mm)	10" (254mm)
EJN-SFC-1200	Floor to Floor	12" (305mm)	20" (508mm)	12" (305mm)
EJN-SFC-200W	Floor to Wall	2" (51mm)	3.5" (89mm)	1" (25mm)
EJN-SFC-400W	Floor to Wall	4" (102mm)	6" (152mm)	2" (51mm)
EJN-SFC-600W	Floor to Wall	6" (152mm)	8.5" (216mm)	3" (76mm)
EJN-SFC-800W	Floor to Wall	8" (203mm)	11" (279mm)	4" (102mm)
EJN-SFC-1000W	Floor to Wall	10" (254mm)	13.5" (343mm)	5" (127mm)
EJN-SFC-1200W	Floor to Wall	12" (305mm)	16" (406mm)	6" (152mm)

Additional options available, email info@nystrom.com for more information.