

# Seismic Fire Barrier Wall System

## INSIDE AND TOP APPLICATION (FLW/FLWw)

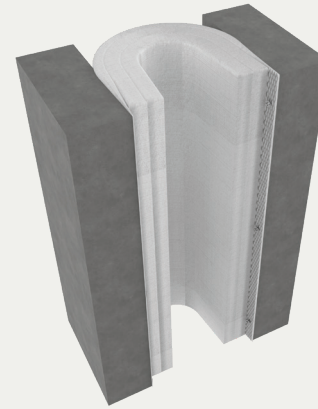

### BENEFITS

**FIRE-RATED** Constructed of fire retardant materials to contain fires from spreading through joint openings. Available in 1, 2 or 3 hour ratings.

**EASY INSTALLATION** The system installs with tongue and groove process with limited or no caulking requirements.

### DETAILS

#### MOVEMENT

- Thermal: Horizontal and Vertical
- Seismic: +/-50% Lateral Shear

#### MOUNTING

- Inside: All sizes
- Top: 4 inches and greater

**JOINT SIZE** 2 Inches to 24 Inches

#### LENGTH

- FLW140: 6.5 Linear Feet
- FLW: 10 Linear Feet up to 12", 4 Linear Feet, 14" and up

**FIRE-RATING** 1, 2 or 3 Hour (3HR is available for 6" and larger joint sizes)

**APPLICATION** Interior

**INSTALLATION** Wall

**COMPLIANCE** Tested in accordance with:

- UL 2079 and CAN ULC S-115 "FTH" (FTH: Rating Fire, Temperature and Hose)
- ASTM E119, E1399, E1966
- BS EN 1366.4

**OPTIONS** Additional Movement, Transitions and Weatherproof Options are Available Upon Request.

### INSTALLATION

#### WALL-TO-WALL/CORNER

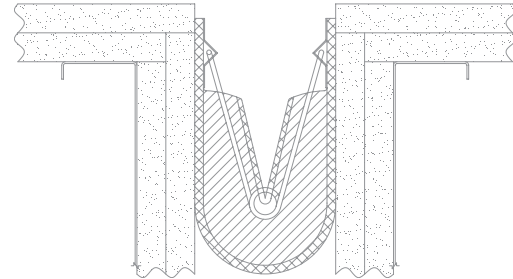

Inside Mount (standard) EJM-FLW140

#### WALL-TO-WALL

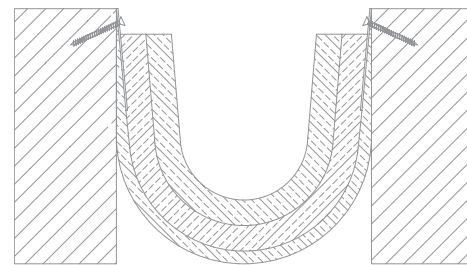

Inside Mount (standard) EJM-FLW

For more information, download our Installation and Operating Manuals (IOM) and Shop Drawings on [Nystrom.com](http://Nystrom.com)

### ORDER GUIDE

| MODEL          | APPLICATION         | JOINT SIZE AT MEAN T°F | TOTAL MOVEMENT |
|----------------|---------------------|------------------------|----------------|
| EJM-FLW140-200 | Wall to Wall/Corner | 2" (51mm)              | 2" (51mm)      |
| EJM-FLW140-300 | Wall to Wall/Corner | 3" (76mm)              | 3" (76mm)      |
| EJM-FLW140-400 | Wall to Wall/Corner | 4" (102mm)             | 4" (102mm)     |
| EJM-FLW-400    | Wall to Wall        | 4" (102mm)             | 4" (102mm)     |
| EJM-FLW-600    | Wall to Wall        | 6" (152mm)             | 6" (152mm)     |
| EJM-FLW-800    | Wall to Wall        | 8" (203mm)             | 8" (203mm)     |
| EJM-FLW-1000   | Wall to Wall        | 10" (254mm)            | 10" (254mm)    |
| EJM-FLW-1200   | Wall to Wall        | 12" (305mm)            | 12" (305mm)    |
| EJM-FLW-1400   | Wall to Wall        | 14" (356mm)            | 14" (356mm)    |
| EJM-FLW-1600   | Wall to Wall        | 16" (406mm)            | 16" (406mm)    |
| EJM-FLW-1800   | Wall to Wall        | 18" (457mm)            | 18" (457mm)    |
| EJM-FLW-2000   | Wall to Wall        | 20" (508mm)            | 20" (508mm)    |
| EJM-FLW-2200   | Wall to Wall        | 22" (558mm)            | 22" (558mm)    |
| EJM-FLW-2400   | Wall to Wall        | 24" (609mm)            | 24" (609mm)    |

| MODEL         | APPLICATION    | JOINT SIZE AT MEAN T°F | TOTAL MOVEMENT |
|---------------|----------------|------------------------|----------------|
| EJM-FLW-400W  | Wall to Corner | 4" (102mm)             | 4" (102mm)     |
| EJM-FLW-600W  | Wall to Corner | 6" (152mm)             | 6" (152mm)     |
| EJM-FLW-800W  | Wall to Corner | 8" (203mm)             | 8" (203mm)     |
| EJM-FLW-1000W | Wall to Corner | 10" (254mm)            | 10" (254mm)    |
| EJM-FLW-1200W | Wall to Corner | 12" (305mm)            | 12" (305mm)    |
| EJM-FLW-1400W | Wall to Corner | 14" (356mm)            | 14" (356mm)    |
| EJM-FLW-1600W | Wall to Corner | 16" (406mm)            | 16" (406mm)    |
| EJM-FLW-1800W | Wall to Corner | 18" (457mm)            | 18" (457mm)    |
| EJM-FLW-2000W | Wall to Corner | 20" (508mm)            | 20" (508mm)    |
| EJM-FLW-2200W | Wall to Corner | 22" (558mm)            | 22" (558mm)    |
| EJM-FLW-2400W | Wall to Corner | 24" (609mm)            | 24" (609mm)    |

Additional options available, email [info@nystrom.com](mailto:info@nystrom.com) for more information.