

Ø3/16" FH DRYWALL
OR MASONRY ANCHOR
AS REQ'D. @ 18" O.C.
(BY INSTALLER) TYP.

3" [76mm]

SEAL COLOR SELECTOR			
BLACK	_____	WHITE	_____
BEIGE	_____	GRAY	_____

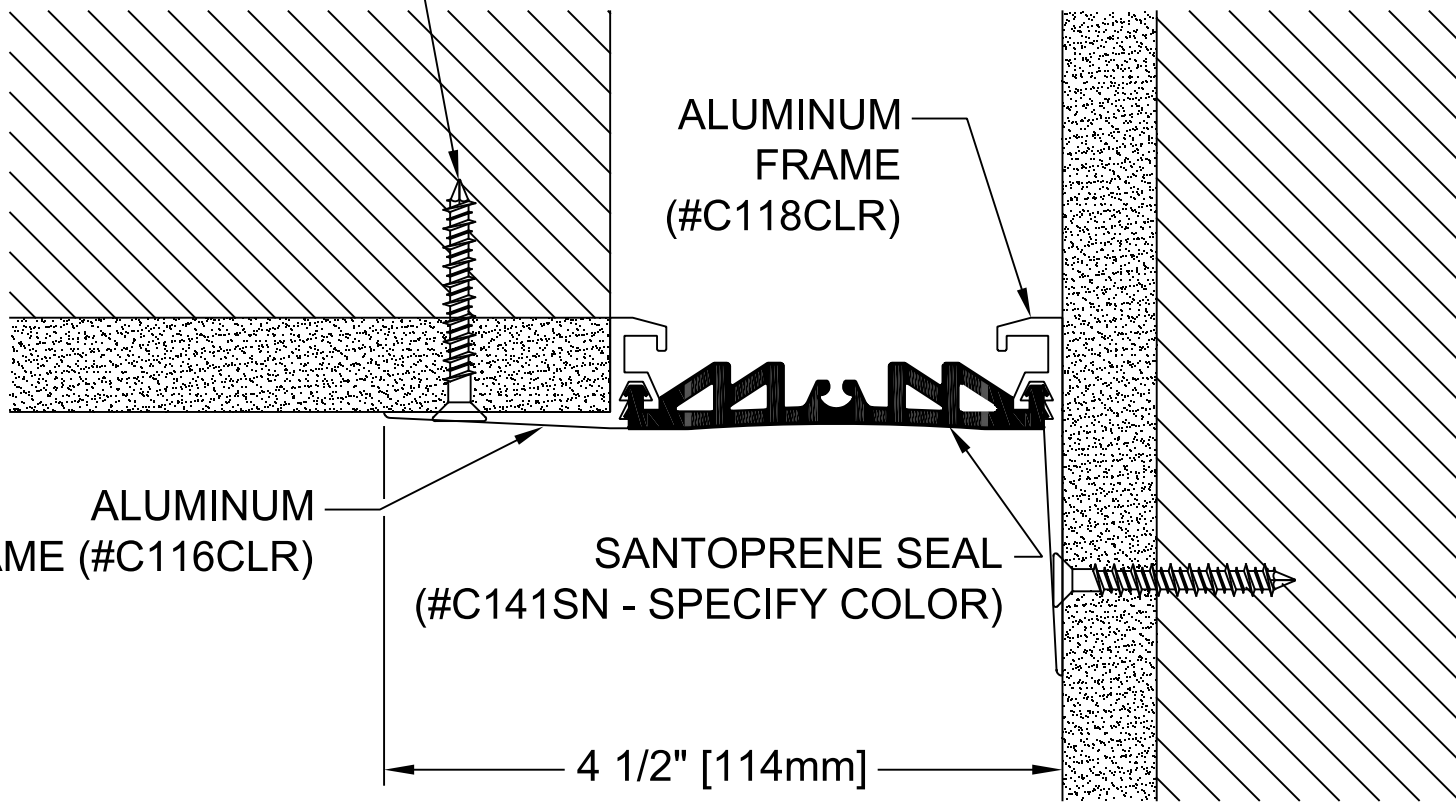

ALUMINUM
FRAME
(#C118CLR)

ALUMINUM
FRAME (#C116CLR)

SANTOPRENE SEAL
(#C141SN - SPECIFY COLOR)

4 1/2" [114mm]

WALL & CEILING CORNER SURFACE APPLICATION

EXPOSED FINISH: CLEAR ANODIZED

MOVEMENT: +/- 25% NOMINAL JOINT WIDTH

STOCK LENGTHS: 10'-0"

PROPRIETARY AND CONFIDENTIAL: THE INFORMATION CONTAINED IN THIS DRAWING, IS SOLE PROPERTY OF NYSTROM. ANY REPRODUCTION IN PART OR AS A WHOLE, WITHOUT THE WRITTEN PERMISSION OF NYSTROM, IS PROHIBITED. © 2020 NYSTROM, INC.

PROJECT:					
ARCHITECT:					
CONTRACTOR:					
QTY:					
PART#:		EJN-LCWS-300W			
 9300 73 rd Ave N., Minneapolis, MN 554428 800-547-2635 info@nystrom.com		TITLE:			
		ELASTOMERIC CORRIDOR WALL & CEILING SYSTEM SURFACE APPLICATION			
	NAME	DATE	SIZE	DWG. NO.	REV
DRAWN	JPK	01/31/23	A	EJN-LCWS-300W	A
RELEASED					WEIGHT: