

# SEISMIC ALUMINUM INFILL FLOORING SYSTEM – NO BUMP APPLICATION

**MODEL(S): SFP WITH INFILL/SFPw WITH INFILL**

## **SFP/w with Infill Floor to Floor Cover System**

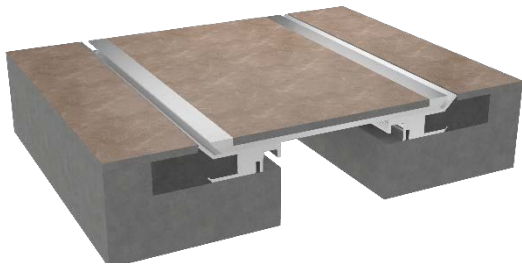

### **GENERAL DESCRIPTION**

Nystrom Architectural Infill/No Bump Seismic System is designed to cover expansion control openings in structural, high-movement floor joints, when standard aluminum is acceptable. The SFP with Infill provides a no bump transition.

**GENERAL SAFETY PRECAUTIONS** Improper selection, installation, or use can cause personal injury or property damage. It is solely the responsibility of the user, through their own analysis, to select products suitable to the specific application requirements, ensure proper maintenance and use as intended. Follow local, state, and federal regulations for proper installation and operation requirements.

### **Introduction + Safety**

Please read the complete instructions carefully before beginning any work. To ensure proper installation and performance of the product, the following actions must be completed by the installing contractor. Failure to do so will affect product warranty.

### **Transportation + Storage**

- Inspect all shipments and materials for missing or damaged components and hardware.
- Material must be stored in a clean, dry location.

### **Preparation**

- Locate the packing slip(s) and/or shop drawings.
- Verify that all products listed on the packing slip included in the package.
- Check the products for damage. If products are damaged, report a freight claim immediately and leave the products in their packaging. If you sign for products without reporting damage, you waive your right to a freight claim and will be responsible for replacement costs.
- Read the instructions thoroughly before beginning installation.

## Tool List

- Tape measure
- Phillips
- Hex screwdriver
- Slotted drivers for anchors
- Level
- Mixing pail (as required for grout)
- Duct tape
- Rubber mallet
- Roofing paper (to protect substrate)
- Trowel
- Chop saw to cut product to length
- Electric drill with proper paddle type mixer
- Broom & dustpan or vacuum

## Personal Protective Equipment recommendations (beyond standard jobsite PPE)

- Safety Glasses
- Safety Boots
- Chemical resistant gloves

## Included with the expansion joint system:

- Ø3/16” x 1-3/4” Tapcon fastener (#27529)
- Centering Bars with associated hardware

## Preinstallation

1. Pour floors with blockouts as shown on shop drawings. The blockout should be a minimum of 2” wider than the exposed cover width by the specified depth.
2. Ensure that the area where the system is being installed is smooth and level. High spots should be ground down and low spots filled in. Make sure all surfaces are clean by brushing or vacuuming the surface.

## INSTALLATION EJN-SFP w/ Infill (Floor-to-Floor only)

1. Remove the factory installed #10-24 screw that attaches the wing plate to the base member frame and retain for reinstallation later. **See Figure 1**

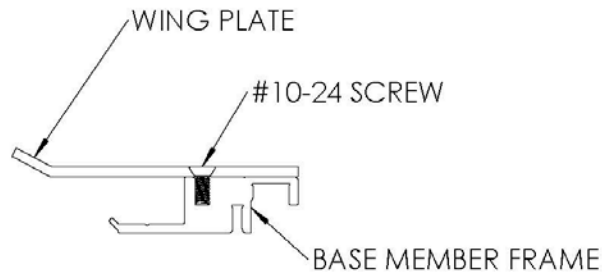

FIGURE 1

2. Position base member frames in blockout per shop drawings. Using the frame as a template mark, drill  $\text{Ø}5/32$ " holes for Tapcon fasteners. Align frame edge with joint face – typical both sides. Install base member frames to the blockout opening with fasteners, making sure not to over tighten. **See Figure 2**

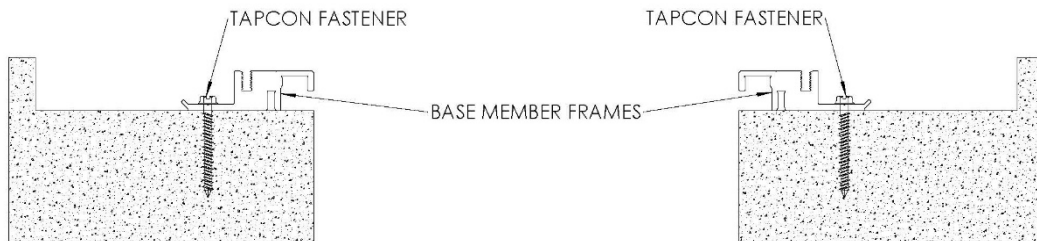

FIGURE 2

3. Reinstall the wing plate to the base member frame with the #10-24 screw. **See Figure 3**

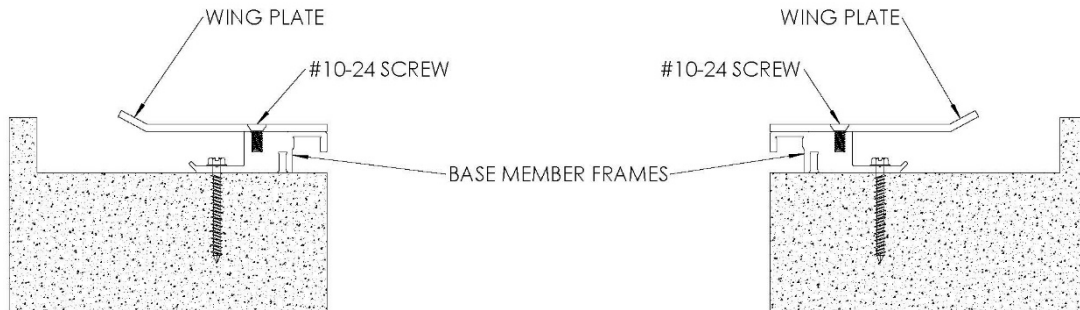

FIGURE 3

4. Protect the exposed surface of the expansion joint, grout in the blockout level with the surrounding floor. **See Figure 4**



FIGURE 4

5. Finish floor (by others) may be installed after grout has cured. **See Figure 5**

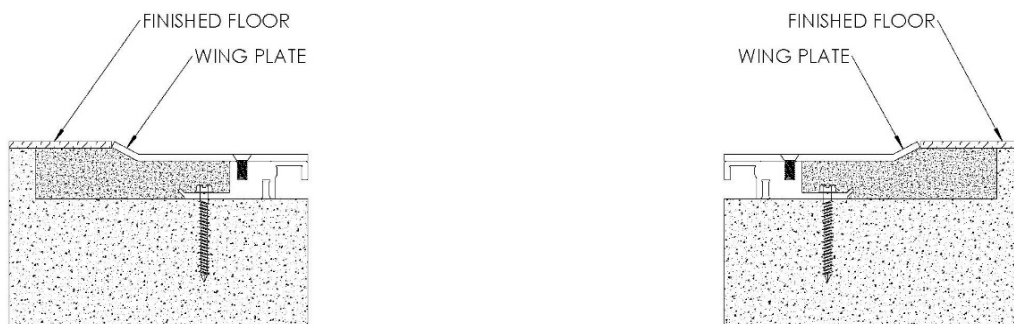

FIGURE 5

- Lay cover plate over the left base frame with ends flush and mark cover plate center holes onto the base frame near the inside edge. Repeat this on the right side. Position the spring assembly in the spring track on the base frames. This is done by sliding the spring assemblies in from the ends of the frames and aligning them with the marked locations. The spring assemblies will be diagonal to the opening. Tape may be needed to hold the spring assembly in place. **See Figure 6**

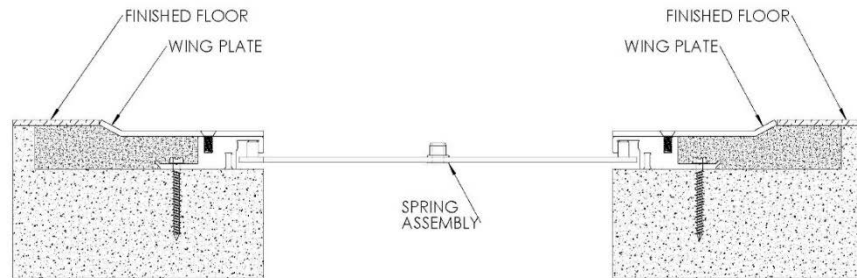

FIGURE 6

- Position the cover plate centered over the base frame and with the center hole aligned with the spring assemblies. Attach the cover plate to the spring assemblies with the provided spring screws. **DO NOT OVERTIGHTEN.** **See Figure 7**

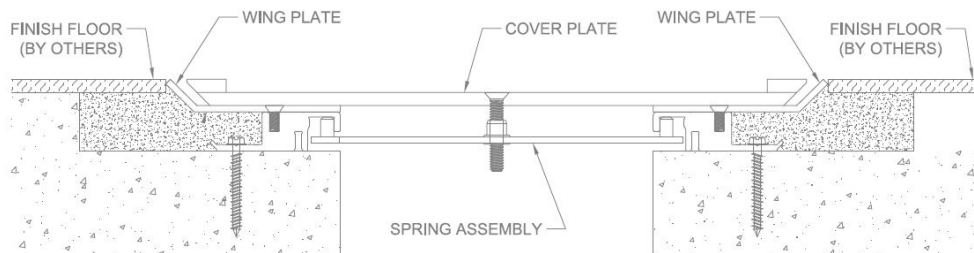

FIGURE 7

- Finish floor (by others) may be installed after cover plate is installed. **See Figure 8**

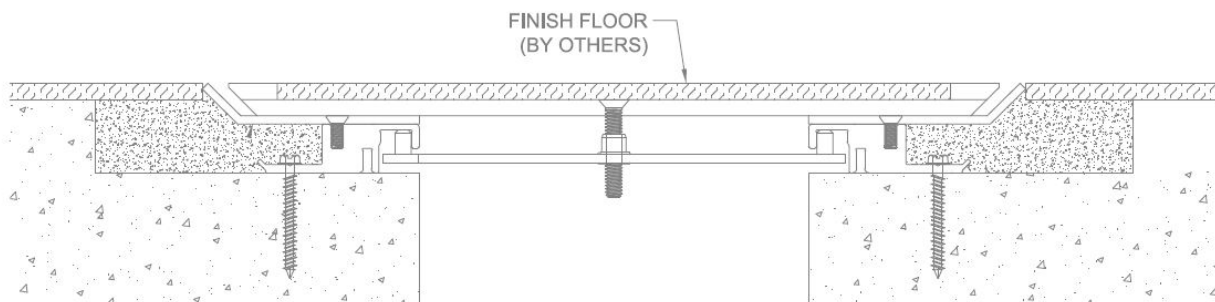
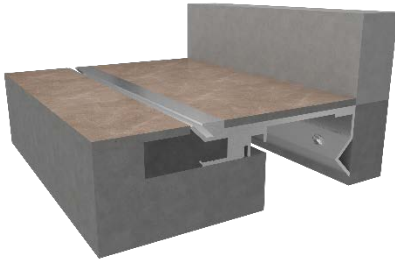

FIGURE 8

## SFPw with Infill Floor to Wall Cover System



### GENERAL DESCRIPTION

Nystrom SFPw with Infill Interior Cover System is designed to match the SFPw with Infill cover plate in floor to wall applications.

### Tool List

- Tape measure
- Phillips
- Hex screwdriver
- Slotted drivers for anchors
- Level
- Mixing pail (as required for grout)
- Duct tape
- Rubber mallet
- Roofing paper (to protect substrate)
- Trowel
- Chop saw to cut product to length
- Electric drill with proper paddle type mixer
- Broom & dustpan or vacuum

### Personal Protective Equipment recommendations (beyond standard jobsite PPE)

- Safety Glasses
- Safety Boots
- Chemical resistant gloves

### Included with the expansion joint system:

- Ø3/16" x 1-3/4" Tapcon fastener (#27529)
- #10 x 5/8" Self-Drilling Screw (#31804)

### Preinstallation

1. Pour floors with blockouts as shown on shop drawings. The blockout should be a minimum of 1" wider than the exposed cover width by the specified depth.
2. Ensure that the area where the system is being installed is smooth and level. High spots should be ground down and low spots filled in. Make sure all surfaces are clean by brushing or vacuuming the surface.

### INSTALLATION EJN-SFP w/ Infill (Floor-to-Wall only)

1. Position base member frame with attached wing plate in blockout per shop drawings, mark on the wall the location that is level with the top of the wing plate. **See Figure 1.**

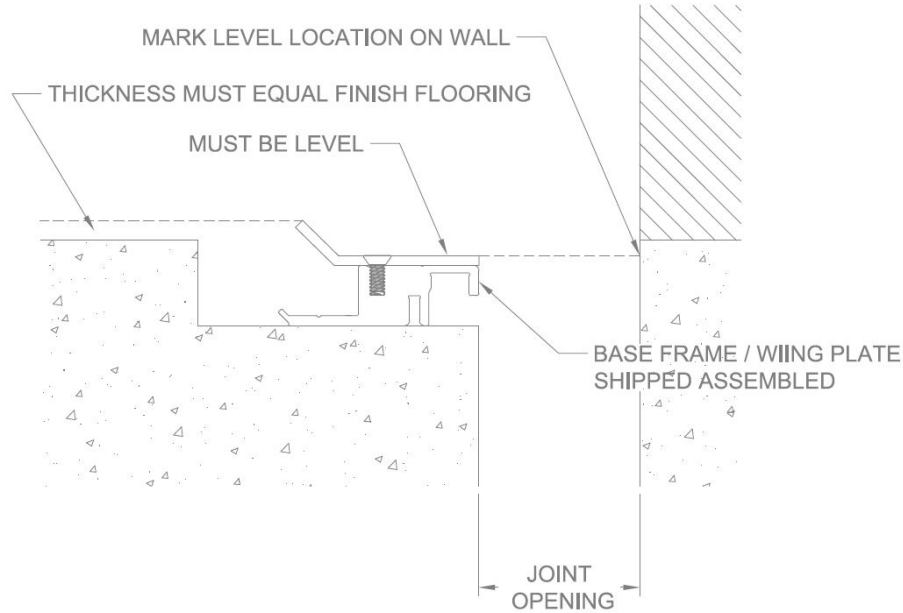

FIGURE 1

2. Remove the assembly from its temporary location in the blockout and remove the factory installed #10-24 screw that attaches the wing plate to the base member frame and retain for reinstallation later. **See Figure 2.**

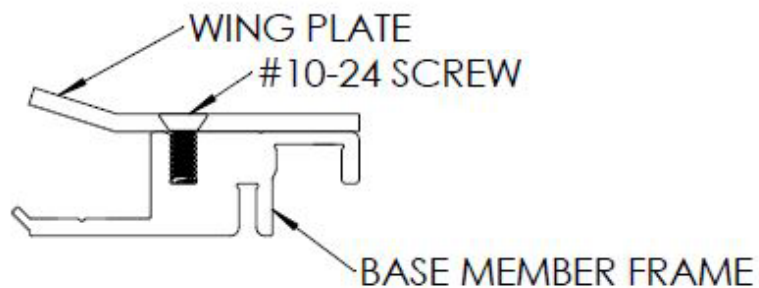
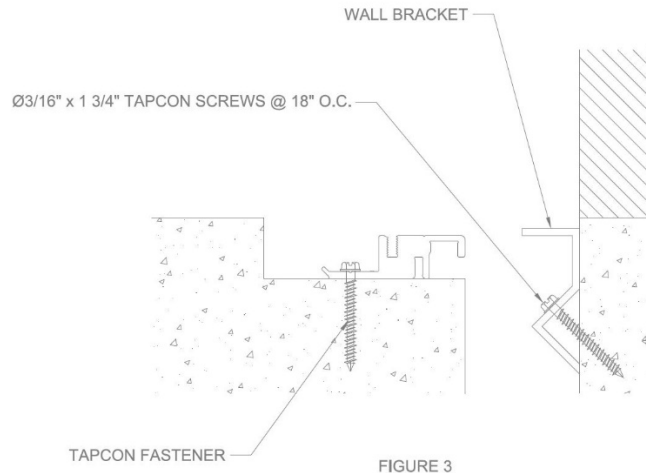
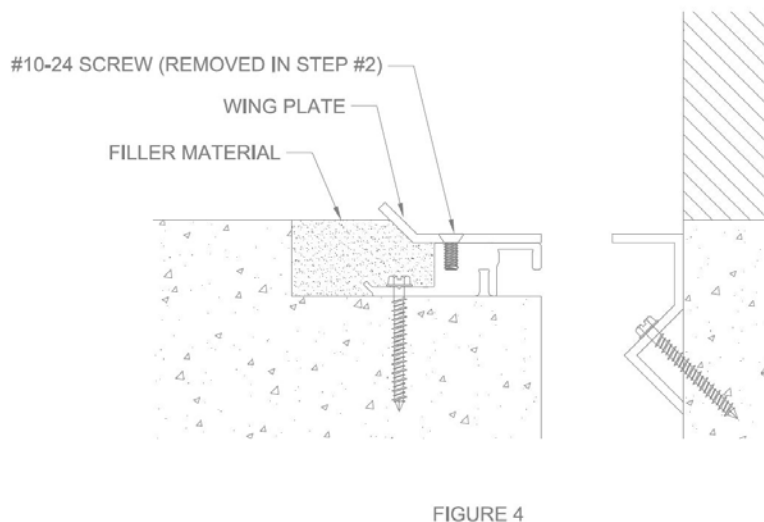

FIGURE 2

- Place wall bracket against the wall with the top of the bracket level with the location marked on the wall, in step 1. Drill  $\text{Ø}5/32$ " into the substrate per the shop drawings and attach the wall bracket to the substrate with the supplied  $\text{Ø}3/16$ " Tapcon anchors. Reinsert base frame (only) into blockout and properly locate. Using the frame as a template, mark, and drill  $\text{Ø}5/32$ " holes for Tapcon fasteners. Align frame edge with joint face. Install base member frame to blockout opening with fasteners, making sure not to over tighten. **See Figure 3.**



- Reinstall the wing plate to the base member frame with the supplied #10-24 screws. Then protect the exposed surface of the expansion joint, grout in the blockout level with the surrounding floor. **See Figure 4.**





5. Position the cover plate over the wing plate & wall bracket so that the top of its horizontal face is level when set and the cover plate is firm against the wall substrate. Install cover plates using supplied #10 x 5/8" self-drilling screws. DO NOT OVERTIGHTEN. Finish floor (both floor and pan, by others) may be installed after grout has cured. **See Figure 5.**

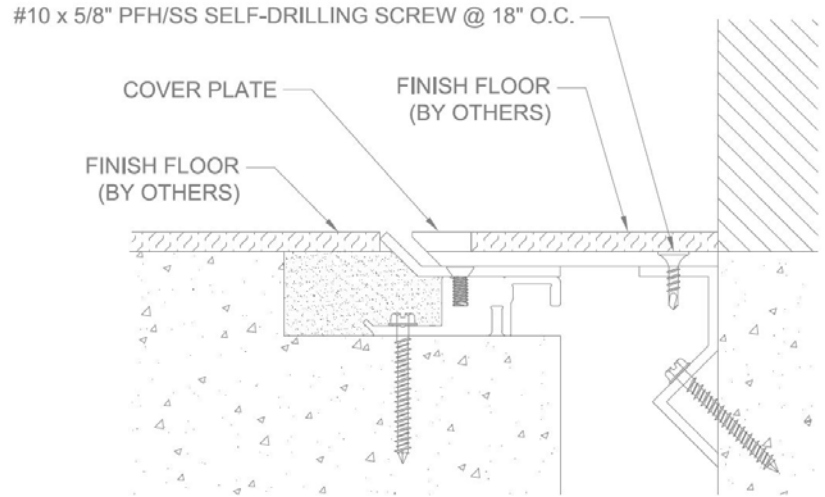

FIGURE 5

## OPERATION

Expansion Joints are designed and built for years of dependable service.

## MAINTENANCE

Perform annual inspections to make sure the system is in position; all fasteners are tight and in place and there is no impedance of joint cover movement. Repair and/or replace as needed.

## QUESTIONS?

For more information on installation, repair, or replacement, please contact Customer & Sales Support at 800-547-2635 or visit [nystrom.com](http://nystrom.com)