

EJ-WCS-400W thru 600W

Expansion Joint Cover System for Walls Wall to Wall Corner Condition

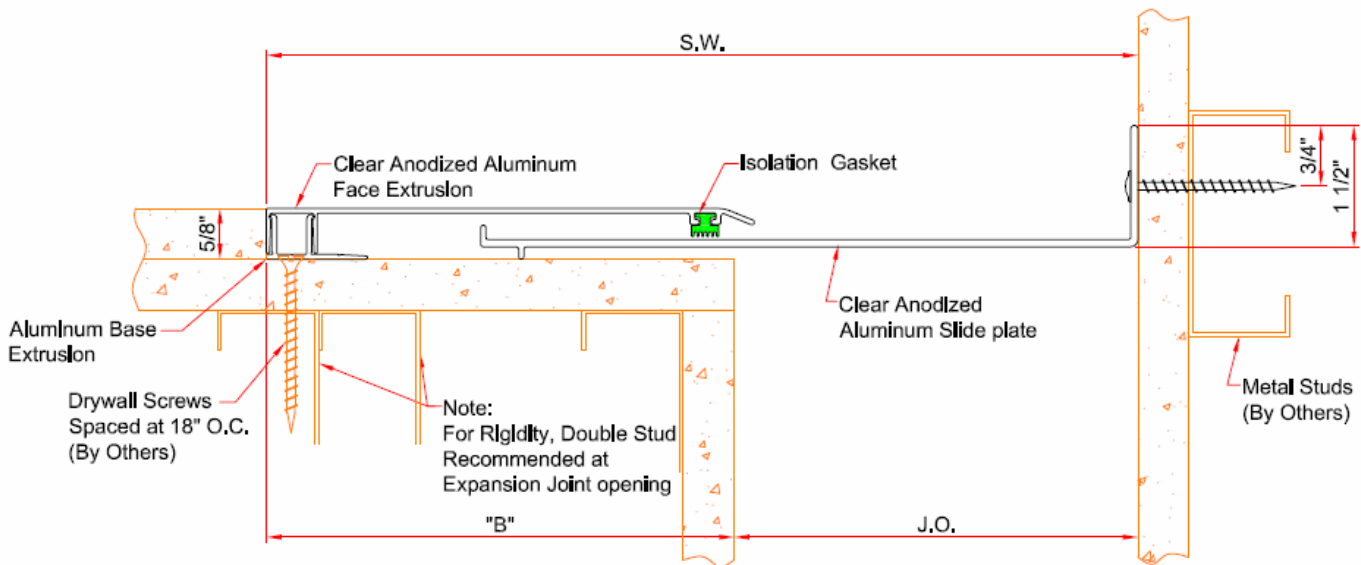

EJ-WCS-400W THRU EJ-WCS-600W DETAIL
WALL-TO-WALL CORNER CONDITION

() - Denotes Millimeters

DIMENSION CHART						
Model	J.O. @ Min.	J.O. @ Mid	J.O. @ Max.	"B"	Total Movement	System Width
WCS-400W	3" (76)	4" (102)	7 1/2" (191)	5 3/4" (146)	4 1/2" (114)	9 3/4" (248)
WCS-500W	3" (76)	5" (127)	7 1/2" (191)	5 3/4" (146)	4 1/2" (114)	10 3/4" (273)
WCS-600W	3" (76)	6" (152)	7 1/2" (191)	5 3/4" (146)	4 1/2" (114)	11 3/4" (298)

Note: Minimum And Maximum Values Are After Movement Occurs. Mid Point Value Is The Recommended Size Of Opening At Installation.



9300 73rd Avenue North
Minneapolis, MN 55428