

# EJ-WCS-800 thru -2400

## Expansion joint cover for walls

### Wall to wall condition

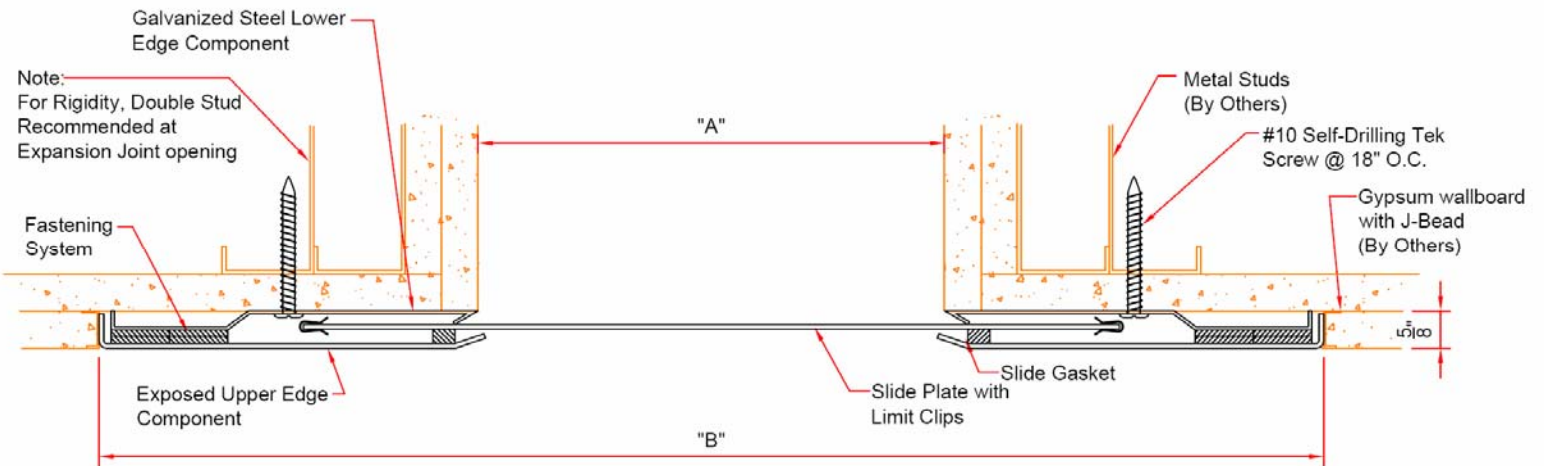

### EJ-WCS-800 THRU EJ-WCS-2400 DETAIL

WALL-TO-WALL CONDITION

( ) - Denotes Millimeters

DIMENSION CHART					
Model	"A" @ Min.	"A" @ Mid	"A" @ Max.	"B" @ Mid.	Total Movement
-WCS-800	4" (102)	8" (203)	12" (305)	20 3/4" (527)	8" (203)
-WCS-1000	5" (127)	10" (250)	15" (381)	24 3/4" (629)	10" (254)
-WCS-1200	6" (152)	12" (305)	18" (457)	28 3/4" (730)	12" (305)
-WCS-1800	9" (229)	18" (457)	27" (686)	40 3/4" (1035)	18" (457)
-WCS-2400	12" (305)	24" (607)	36" (914)	52 3/4" (1340)	24" (610)

Note: Minimum And Maximum Values Are After Movement Occurs. Mid Point Value Is The Recommended Size Of Opening At Installation.



9300 73rd Avenue North  
Minneapolis, MN 55428