

"
CLEAR
OPENING
WIDTH

"
CLEAR
OPENING
LENGTH

FLOOR ASSEMBLY

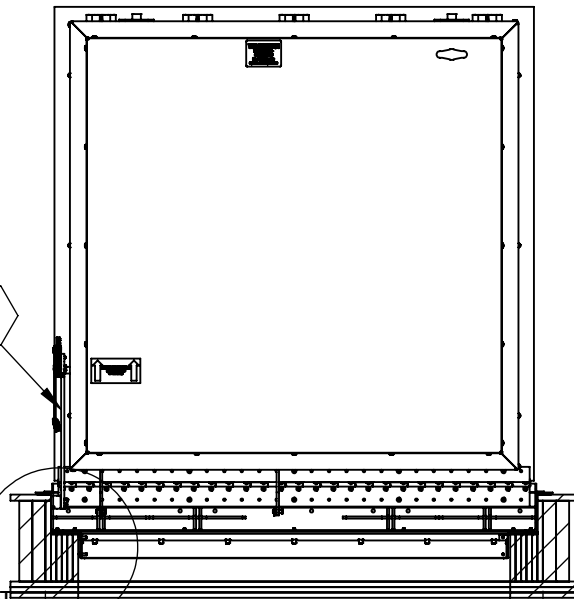

"
OPENING
LENGTH

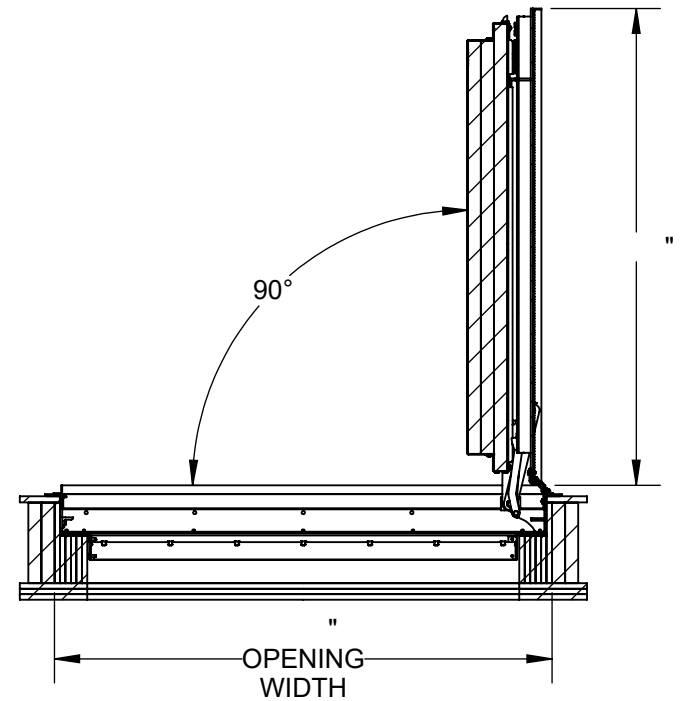

"
OPENING
WIDTH

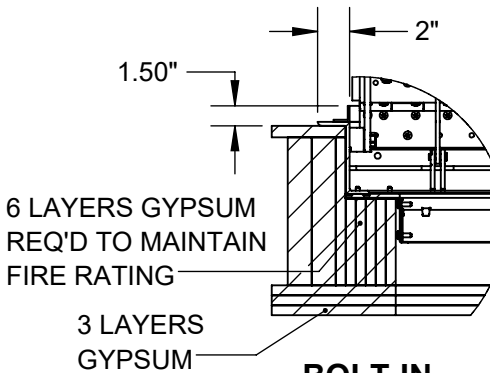

6 LAYERS GYPSUM
REQ'D TO MAINTAIN
FIRE RATING

3 LAYERS
GYPSUM

**BOLT-IN
DETAIL**

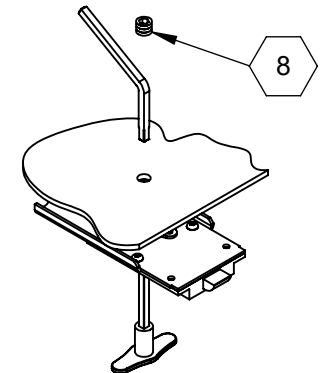

SLAM LATCH DETAIL



9300 73rd Avenue North
Minneapolis, MN 55428

TITLE:

FD, 2hr Fire Rated, 250 psf,
, Sngl Dr, Alum, 1/4" Smth Plt, 1" Pan,
Mill, Angle Frame, Bolt-In,
SST Spring Asst, 316 SST HDW, Slam Latch w/Hdl

	NAME	DATE	SIZE	DWG. NO.	REV
DRAWN	BES		A	Nystrom FD FDFPA_X_SWL-BI-P1 ShpDr	
RELEASED	BES		WEIGHT:		SHEET 2 OF 2