

B

B

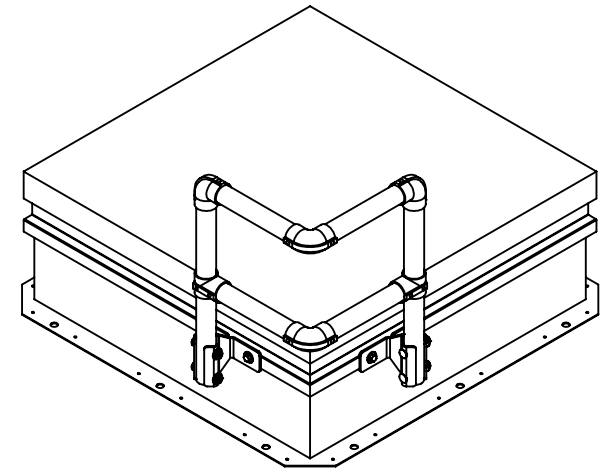
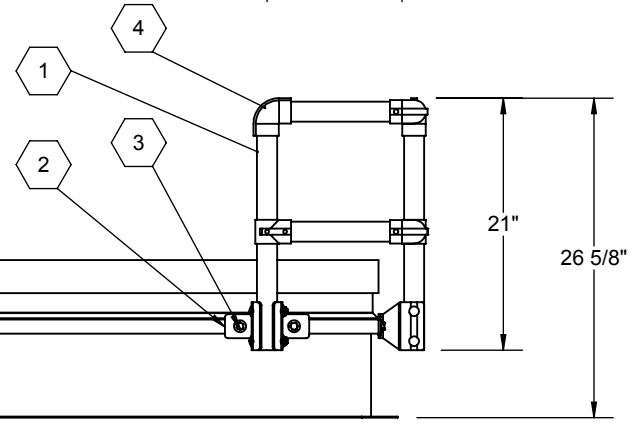
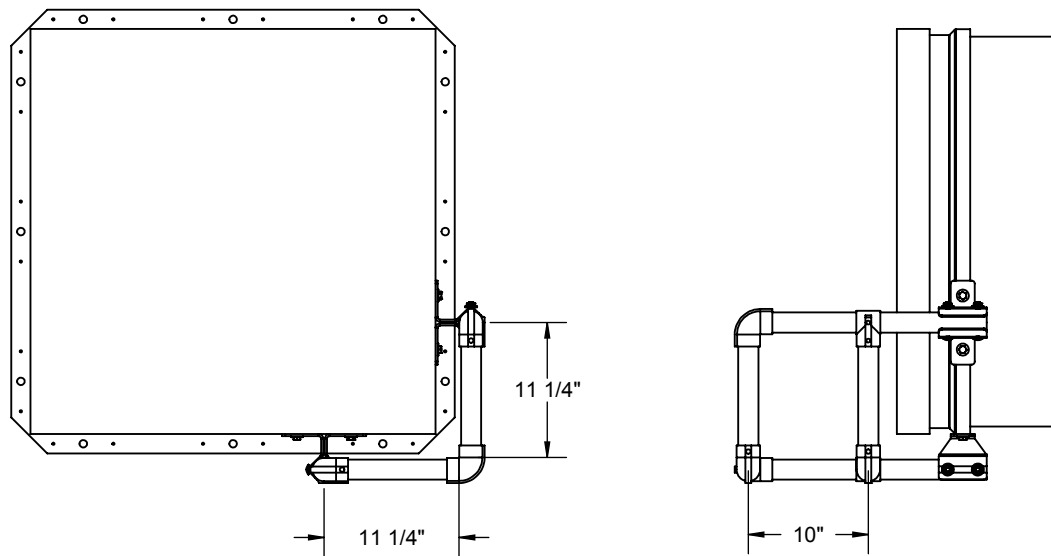

A

A

SPECIFICATIONS

- ① **RAILS, POSTS:** 6061 T6 ALUMINUM ALLOY 1 1/4" I.D. SCH 40
- ② **COUNTERFLASH MOUNTING BRACKETS:** 3/16" ZINC PLATED STEEL FASTENED TO STEEL BACKING PLATE
- ③ **BOLTS:** HEX HEAD BOLTS 3/8"-16 x 3/4" GRADE 5 ZINC PLATED
- ④ **RAILING FITTINGS AND PLUGS:** MANUFACTURER'S STANDARD CAST WITH SET SCREW HOLD
- 5. NOT FOR USE ON ROOF HATCHES WITHOUT COUNTERFLASHING. CORNER GRABS SIZE AND TOP RAIL LOCATION BASED ON STANDARD ROOF HATCHES.
- 6. FINISH: SAFETY YELLOW POWDER COAT PAINT

PROPRIETARY AND CONFIDENTIAL: THE INFORMATION CONTAINED IN THIS DRAWING IS THE SOLE PROPERTY OF NYSTROM. ANY REPRODUCTION IN PART OR AS A WHOLE WITHOUT THE WRITTEN PERMISSION OF NYSTROM IS PROHIBITED.

PROJECT:			
ARCHITECT:			
CONTRACTOR:			
QTY:			
PART#:		SGBAY	
nystrom Company Address		TITLE: Safety Grab Bar For Roof Hatch Steel, Safety Yellow Pwd,	
NAME	DATE	SIZE	DWG. NO.
DRAWN SJB	6/24/14	A	SGBAY
RELEASED	PGE 6/24/14	WEIGHT: NA	SHEET 1 OF 2

ITEM NO.	PART NUMBER	DESCRIPTION	QTY.
10	27496-10.00	RAIL, 1-1/4" X 10.00L, ALUM	4
510	27185	FTG, ELBOW,	4
515	27188	FTG, TEE,	2
580	27349-A	PKG, SIDE POST, ALUM, NO FTG	2

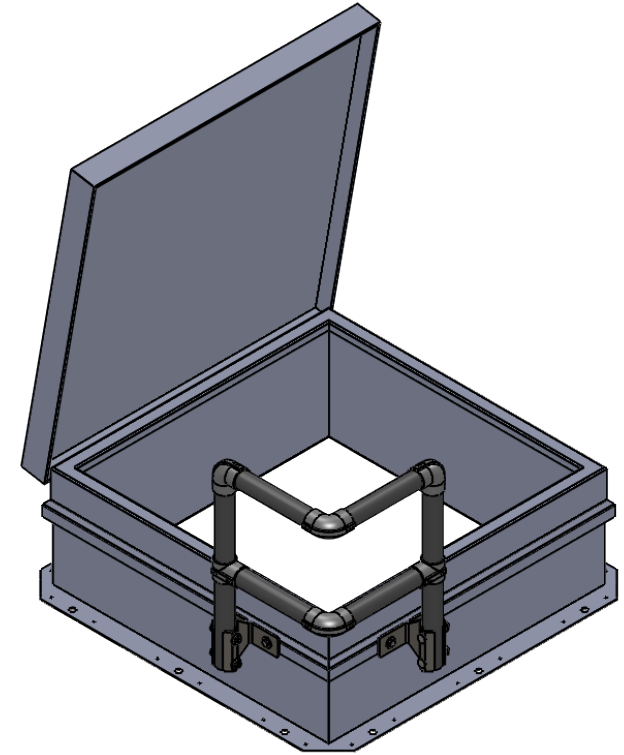
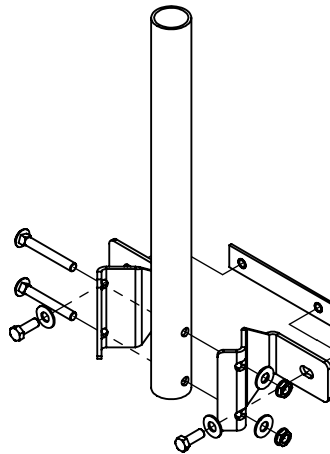
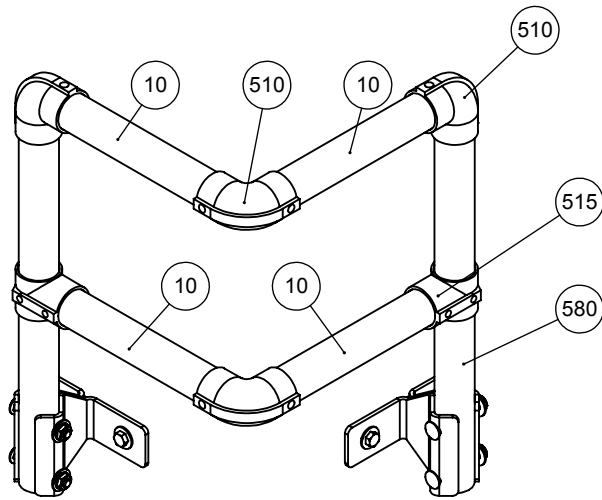

(ROOF HATCH SHOWN FOR ILLUSTRATIVE PURPOSES ONLY)

INSTALLATION NOTES:

1. TO DRILL HOLES IN COUNTERFLASHING TO MOUNT CORNER GRAB, TEMPORARILY ASSEMBLE THE CORNER BRAB BRACKETS AND MARK MOUNTING HOLES ON EACH CORNER. DRILL 1/2" DIAMETER HOLES THROUGH COUNTERFLASHING OF CURB.
2. REFERENCE MANUFACTURING INSTALLATION INSTRUCTIONS FOR FURTHER DETAILS.

PROPRIETARY AND CONFIDENTIAL: THE INFORMATION CONTAINED IN THIS DRAWING IS THE SOLE PROPERTY OF NYSTROM. ANY REPRODUCTION IN PART OR AS A WHOLE WITHOUT THE WRITTEN PERMISSION OF NYSTROM IS PROHIBITED.

PROJECT:		
ARCHITECT:		
CONTRACTOR:		
QTY:		
PART#:		SGBAY
nystrom Company Address		TITLE: Safety Grab Bar For Roof Hatch Steel, Safety Yellow Pwd,
NAME	DATE	SIZE
DRAWN SJB	6/24/14	A
RELEASED	PGE	6/24/14
DWG. NO.		REV
SGBAY		A
WEIGHT: NA		SHEET 2 OF 2