

SPECIFICATIONS:

- ① **DOOR:** ALUMINUM, 3/16" DIAMOND PLATE, MILL FINISH WITH A LIVE LOAD OF 150 PSF WITH A MAXIMUM DEFLECTION OF L/160,
- ② **FRAME:** ALUMINUM, 3/16" EXTRUSION, EPOXY PAINT FINISH ON EXTERIOR SURFACES THAT COME IN CONTACT WITH CONCRETE
- ③ **HINGES:** TYPE 316 STAINLESS STEEL
- ④ **SLAM LATCH:** TYPE 316 STAINLESS STEEL WITH INSIDE LEVER HANDLE AND OUTSIDE REMOVABLE 5/16" SQUARE L HANDLE - NPT PLUG
- ⑤ **COUNTER-BALANCE SPRING:** TYPE 17-7 STAINLESS STEEL SPRING ENCLOSED IN A TYPE 316 STAINLESS STEEL TELESCOPING TUBE
- ⑥ **HOLD-OPEN ARM:** TYPE 316 STAINLESS STEEL WITH RED VINYL GRIP HANDLE
- ⑦ **LIFTING HANDLE:** TYPE 316 STAINLESS STEEL
- ⑧ **PADLOCK HASP:** ALUMINUM, WELDED TO DOOR/FRAME
- ⑨ **GASKET:** EPDM, AROUND PERIMETER ON DOOR

PROPRIETARY AND CONFIDENTIAL: THE INFORMATION CONTAINED IN THIS DRAWING IS THE SOLE PROPERTY OF NYSTROM. ANY REPRODUCTION IN PART OR AS A WHOLE WITHOUT THE WRITTEN PERMISSION OF NYSTROM IS PROHIBITED.

| | | | | | |
|---|------|---------|-------------|------------------------------|--------------|
| PROJECT: | | | | | |
| ARCHITECT: | | | | | |
| CONTRACTOR: | | | | | |
| QTY: | | | | | |
| PART#: | | | | | |
| 9300 73rd Avenue North Brooklyn Park, MN 55428 | | | | TITLE: | |
| | | | | FLOOR DOOR, SURFACE MOUNT | |
| NAME | DATE | SIZE | DWG. NO. | REV | |
| DRAWN | JPB | 10-4-12 | A | FDNLA_X_SELN-GOLDSM | A |
| RELEASED | TR | 10-4-12 | WEIGHT: TBD | | SHEET 1 OF 2 |

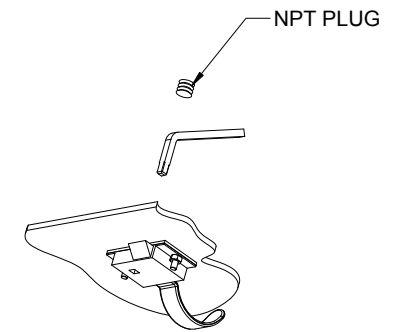
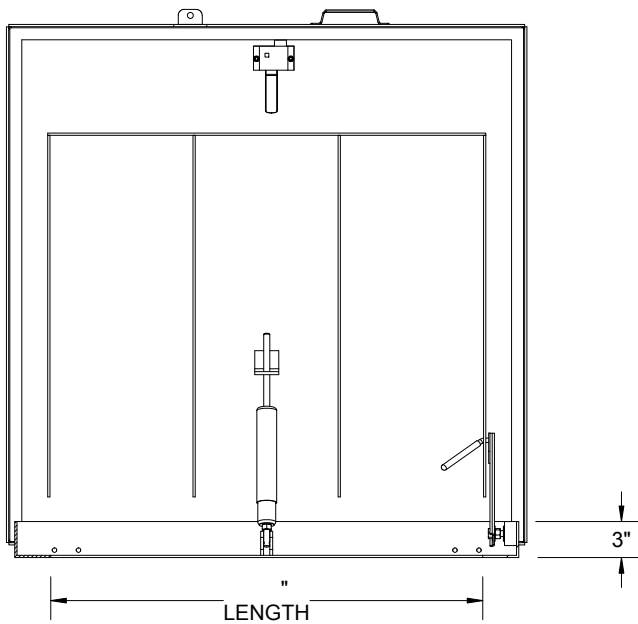
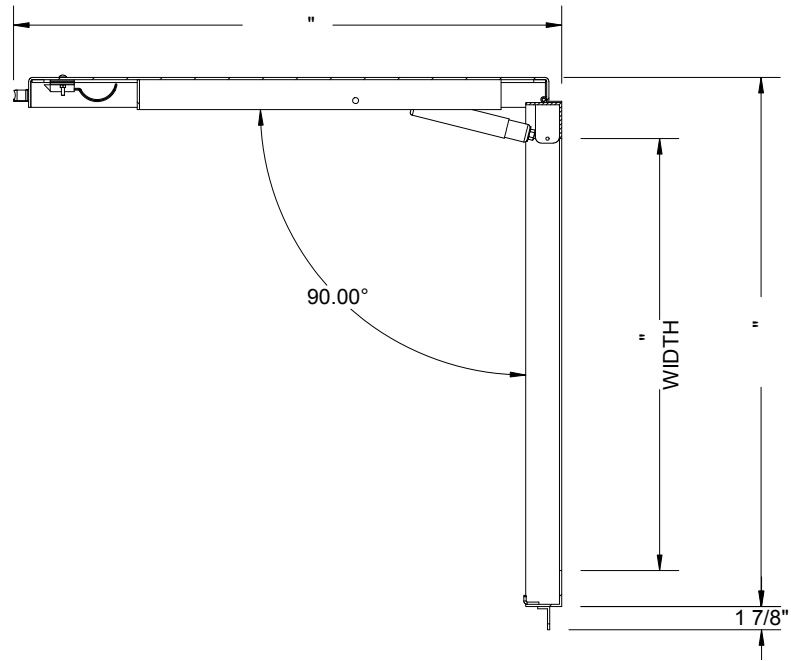
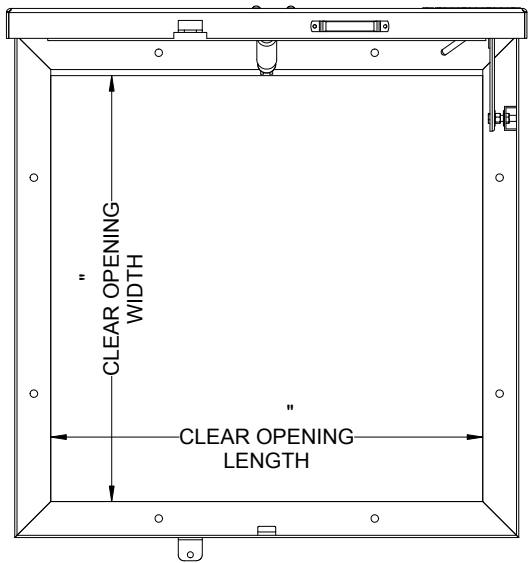

SLAM LATCH DETAIL

| | | | | | |
|---|------|---------|---------------------------------|---------------------|--------------|
| | | | TITLE: FLOOR DOOR SURFACE MOUNT | | |
| 9300 73rd Avenue North Brooklyn Park, MN 55428 | | | - | | |
| | NAME | DATE | SIZE | DWG. NO. | REV |
| DRAWN | JPB | 10-4-12 | A | FDNLA_X_SELN-GOLDSM | |
| RELEASED | TR | 10-4-12 | WEIGHT: TBD | | SHEET 2 OF 2 |