

EJ-WCS-100W thru 300W

Expansion joint cover for walls

Wall to corner condition

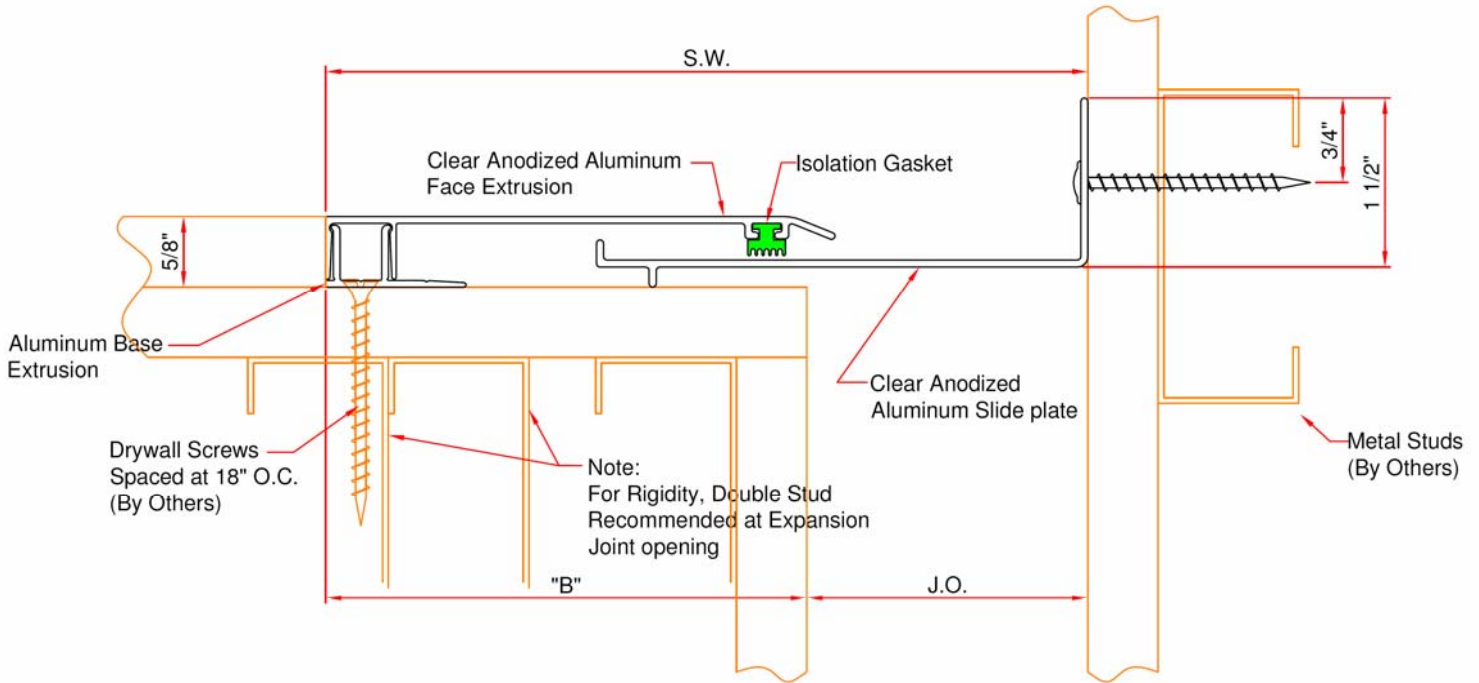

EJ-WCS-100W THRU EJ-WCS-300W
WALL-TO-WALL CORNER CONDITION

() - Denotes Millimeters

DIMENSION CHART						
Model	J.O. @ Min.	J.O. @ Mid	J.O. @ Max.	"B"	Total Movement	System Width
-WCS-100W	1/2" (13)	1" (25)	3 1/2" (89)	4 1/2" (114)	3" (76)	5 1/2" (140)
-WCS-200W	3/4" (19)	2" (51)	3 3/4" (95)	4 1/4" (108)	3" (76)	6 1/4" (159)
-WCS-300W	3/4" (19)	3" (76)	3 3/4" (95)	4 1/4" (108)	3" (76)	7 1/4" (184)

Note: Minimum And Maximum Values Are After Movement Occurs. Mid Point Value Is The Recommended Size Of Opening At Installation.