

SPECIFICATIONS:

- ① **DOOR:**
ALUMINUM 1/4" DIAMOND PLATE, MILL FINISH WITH A LIVE LOAD OF 300PSF WITH A MAXIMUM DEFLECTION OF L/150
- ② **FRAME:**
ALUMINUM, 1/4" EXTRUSION, GRAY PRIMER FINISH ON EXTERIOR SURFACES THAT COME INTO CONTACT WITH CONCRETE
- ③ **HINGES:** TYPE 316 STAINLESS STEEL
- ④ **SLAM LATCH:**
TYPE 316 STAINLESS STEEL WITH INSIDE LEVER HANDLE AND OUTSIDE REMOVABLE HANDLE
- ⑤ **COUNTER-BALANCE SPRING:**
ENCLOSED, TYPE 17-7 SST SPRING
- ⑥ **HOLD-OPEN ARM:**
TYPE 316 STAINLESS STEEL WITH RED VINYL GRIP HANDLE

- ⑦ **DRAINAGE COUPLING:** 1-1/2", FOR CONNECTION TO RUN
- ⑧ **FLUSH TYPE PLUG SEAL:** TYPE 316 STAINLESS STEEL
- ⑨ **GASKET:** EPDM AIR TIGHT GASKET
- ⑩ **SAFETY GRATE:**
ALUMINUM, 6" SERRATED RAILS WITH SAFETY ORANGE POWDER COAT, LIVE LOAD OF 300PSF, SST HINGES AND INTEGRAL PADLOCK HASP
- ⑪ **NUT-RAIL:** ALUMINUM NUT-RAIL ON HINGE AND LATCH SIDES
- ⑫ **ANCHOR:** ANGLE TABS WITH ϕ 1/2" MNTG HOLES PROVIDED

Á
Á

PROJECT:				
ARCHITECT:				
CONTRACTOR:				
QTY:				
PART#:				
nystrom 9300 73rd Avenue North, Minneapolis, MN 55428	TITLE: FD, Drainable, 300 PSF, Sngl Dr, Alum, Mill, Gray Primer, Bolt-In, SST Spring Asst, 316 SST Hdw, Odor Gasket, Slam Latch W/Hdl, Safety Grate, Alum, Orange			
NAME	DATE	SIZE	DWG. NO.	REV
DRAWN JPB	4/19/18	A	Nystrom FD FDDPA_X_SFL-BI-SGT ShpDr	A
RELEASED TR	4/19/18	WEIGHT:		SHEET 1 OF 2

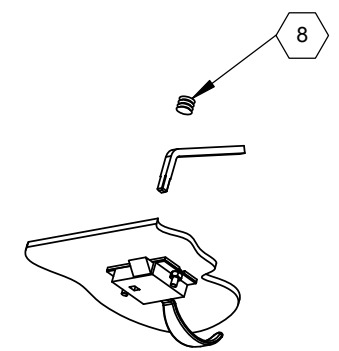
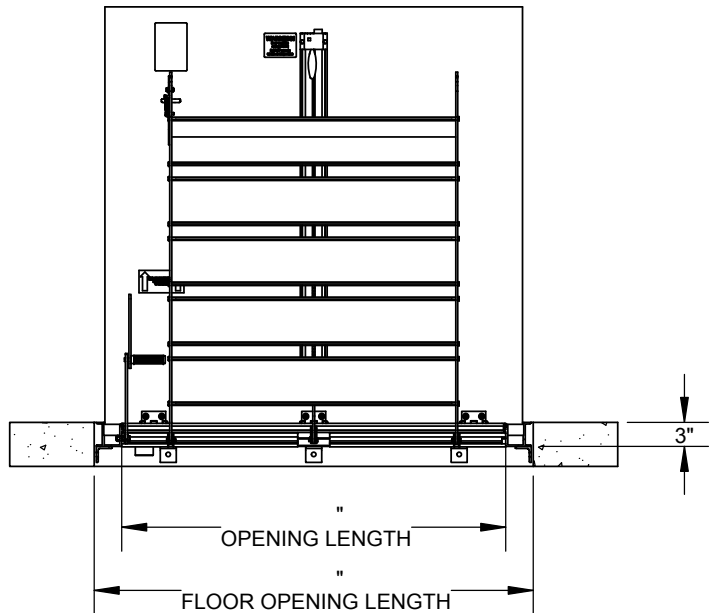
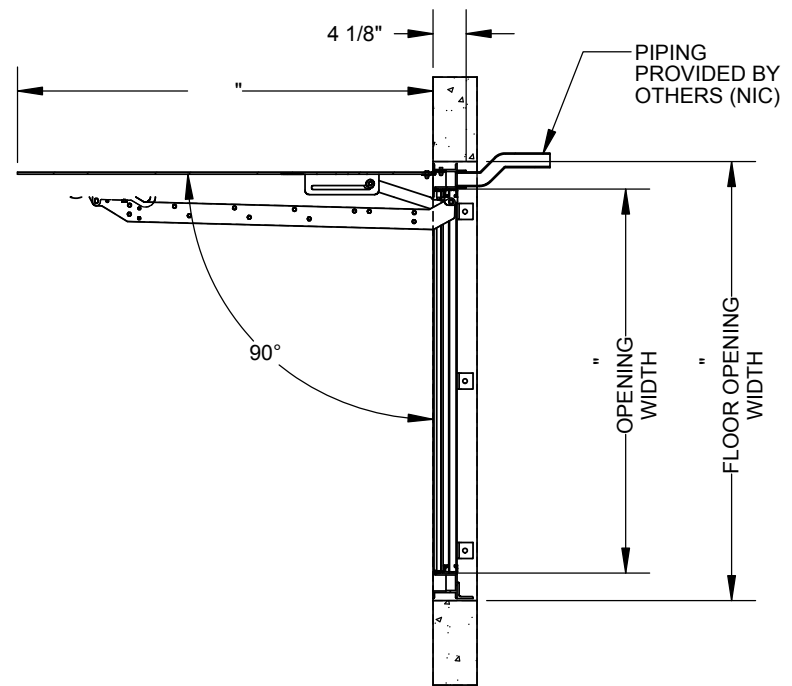
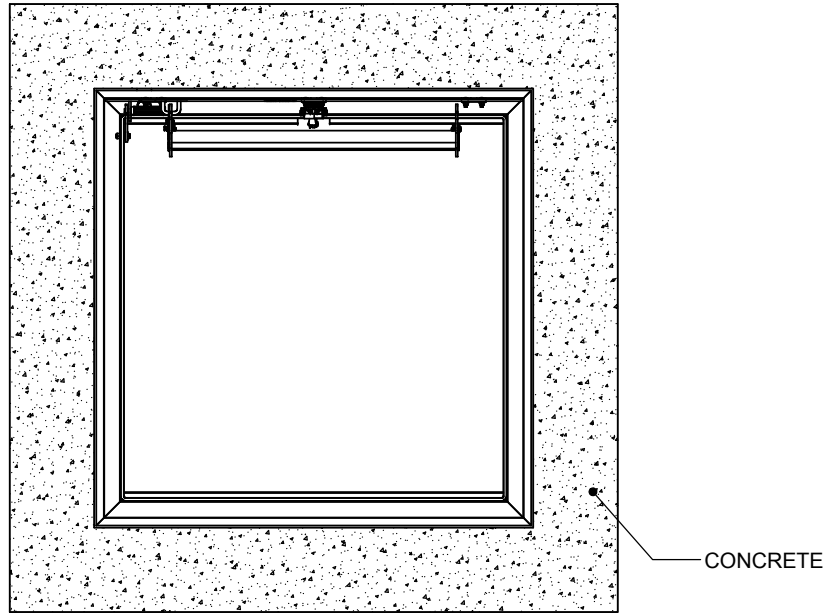

SLAM LATCH DETAIL

				TITLE: FD, Drainable, 300 PSF, Sngl Dr, Alum, Mill, Gray Primer, Bolt-In, SST Spring Asst, 316 SST Hdw, Odor Gasket, Slam Latch W/Hdl, Safety Grate, Alum, Orange	
9300 73rd Avenue North Minneapolis, MN 55428				REV A	
DRAWN	JPB	DATE	4/19/18	SIZE	A
RELEASED	TR	DATE	4/19/18	DWG. NO.	Nystrom FD FDDPA_X_SFL-BI-SGT ShpDr
				WEIGHT:	
					SHEET 2 OF 2

PROPRIETARY AND CONFIDENTIAL: THE INFORMATION CONTAINED IN THIS DRAWING IS THE SOLE PROPERTY OF NYSTROM. ANY REPRODUCTION IN PART OR AS A WHOLE WITHOUT THE WRITTEN PERMISSION OF NYSTROM IS PROHIBITED.