

GV12C

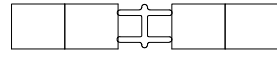

GV12CC

QTY	MODEL	WIDTH	LENGTH	FINISH	LOCATION

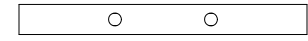
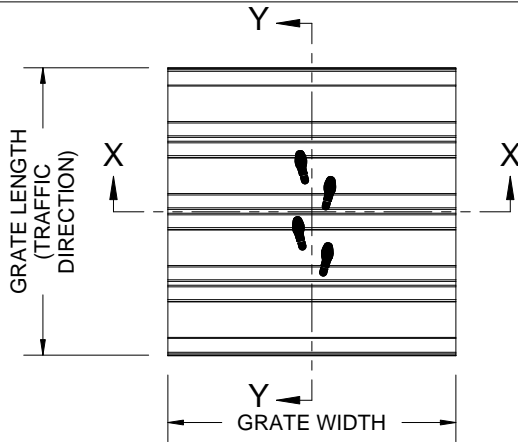

SECTION X-X

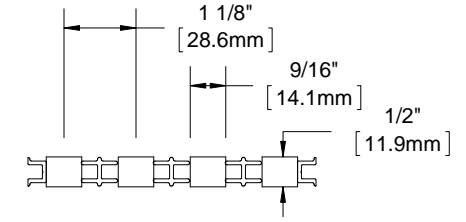

SECTION Y-Y

SINGLE TREAD

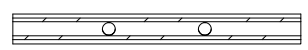
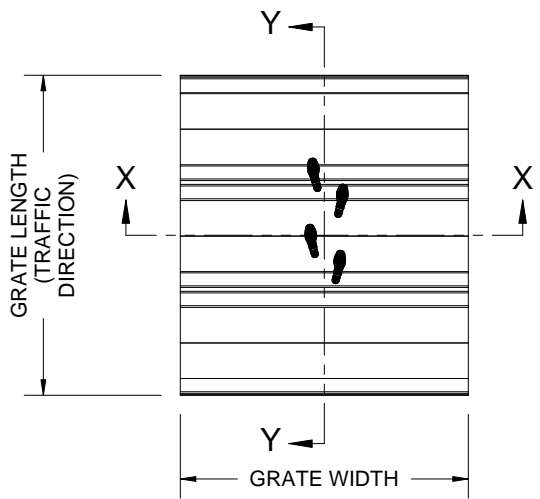

SECTION X-X

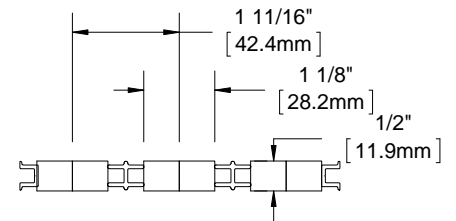

SECTION Y-Y

DOUBLE TREAD

- NOTES:**
- VERIFY TRAFFIC DIRECTION
 - ALL RAIL COMPONENTS ARE MADE OF 6063-T6 ALUMINUM ALLOY
 - TREAD RAILS MUST RUN PERPENDICULAR TO TRAFFIC DIRECTION
 - ADDITIONAL INFORMATION CAN BE FOUND IN THE PRODUCT SPECIFICATION AND IS CONSIDERED PART OF THIS TRANSMITTAL.

PROJECT:			
ARCHITECT:			
CONTRACTOR:			
<p>9300 73rd Avenue North Minneapolis, MN 55428</p>		DESCRIPTION:	
		envIRONtread II®, 15/32", Reversible Recycled Rubber Grate	
	NAME	DATE	SIZE
DRAWN	DKL	4/20/15	A
RELEASED	PE	4/20/15	SCALE: NTS
DWG. NO.		GV12C-NF	
SHEET 1 OF 1		REV B	

PROPRIETARY AND CONFIDENTIAL: THE INFORMATION CONTAINED IN THIS DRAWING IS THE SOLE PROPERTY OF NYSTROM. ANY REPRODUCTION IN PART OR AS A WHOLE WITHOUT THE WRITTEN PERMISSION OF NYSTROM IS PROHIBITED.