

# Seismic Elastomeric

## CORRIDOR SYSTEM (LCH)

Nystrom's Seismic Elastomeric Corridor System is a system dedicated to limiting the sight line of the expansion joint by mounting inside the joint opening, and allows a color selection to match your surrounding substrate and finish material. This system accommodates seismic movement.



### FEATURES

**MAXIMUM MOVEMENT** Deep "V" design allows for maximum thermal and seismic movement.

**COMPLEMENTARY SEAL COLORS** Available in four elastomeric seal color options: beige, white, gray or black.

**CONTINUOUS SIGHT LINE** This system can be used on walls, ceilings and corners to provide seamless and continuous aesthetics.

### DETAILS

**MATERIAL** 6063-T6 Aluminum with Rubber Seal

**FINISH** Mill

#### MOVEMENT

- Thermal: Horizontal and Vertical
- Seismic: Lateral Shear

**MOUNTING** Flush

**JOINT SIZE** 1 inch to 6 inches

**SEAL LENGTH** Continuous

**APPLICATION** Interior

**INSTALLATION** Wall or Ceiling

**OPTIONS** Seal Color

### SEAL COLORS

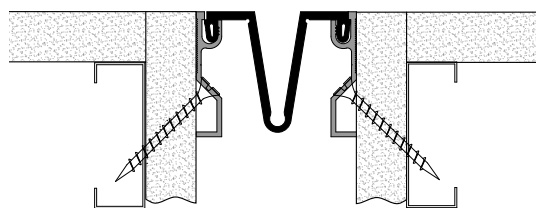

Wall/Ceiling Corner

### MODELS

MODEL	INSTALLATION	JOINT SIZE AT MEAN T°F	SYSTEM WIDTH	TOTAL MOVEMENT
LCH-100	Wall-to-Wall or Wall/Ceiling Corner	1" (25mm)	1" (25mm)	0.5" (13mm)
LCH-200	Wall-to-Wall or Wall/Ceiling Corner	2" (51mm)	2" (51mm)	2" (51mm)
LCH-300	Wall-to-Wall or Wall/Ceiling Corner	3" (76mm)	3" (76mm)	3" (76mm)
LCH-400	Wall-to-Wall or Wall/Ceiling Corner	4" (102mm)	4" (102mm)	4" (102mm)
LCH-500	Wall-to-Wall or Wall/Ceiling Corner	5" (127mm)	5" (127mm)	5" (127mm)
LCH-600	Wall-to-Wall or Wall/Ceiling Corner	6" (152mm)	6" (152mm)	6" (152mm)