

SECTION A-A

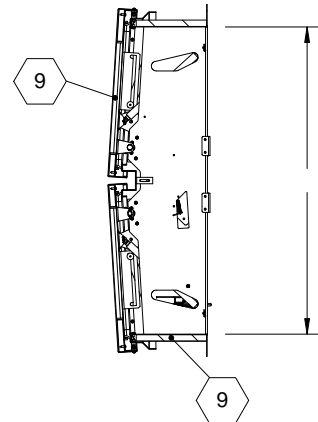

SECTION B-B

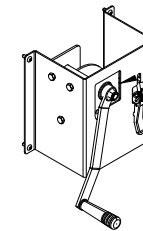
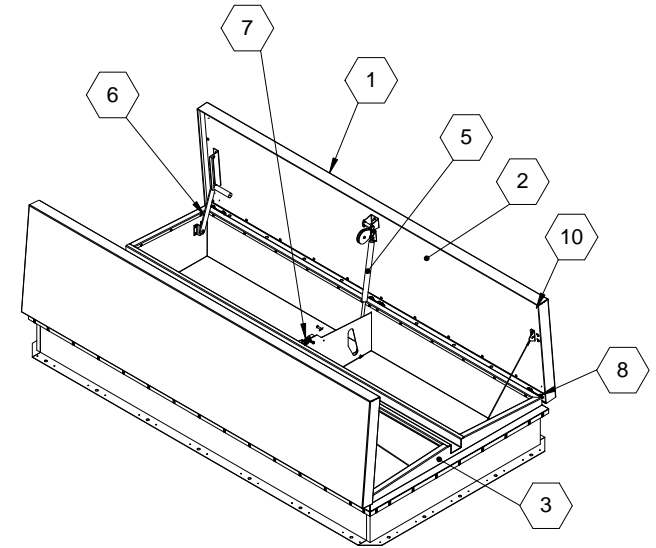

LOWER WINCH

## SPECIFICATIONS:

① **COVER:** 14 GAUGE GALVANNEAL COVER STIFFENED TO WITHSTAND A LIVE LOAD OF 40 PSF WITH A MAX DEFLECTION OF 1/150 OF THE SPAN

② **LINER:** 22 GAUGE GALVANNEAL

③ **CURB AND COUNTERFLASH W/ EZ TAB:**

14 GAUGE GALVANNEAL

④ **FINISH:** COVER - Powder Coat, ANSI 70 Gray  
CURB - Powder Coat, ANSI 70 Gray

⑤ **GAS SPRING WITH DAMPER:** DESIGNED TO OPEN AGAINST A 10PSF SNOW LOAD IN NOT LESS THAN 2 SECONDS

⑥ **HOLD OPEN ARM:** LOCK COVER IN FULLY OPEN POSITION - ZINC PLATED STEEL

⑦ **LATCH:** ZINC PLATED ROTARY LATCH ASSEMBLY DESIGNED TO HOLD COVERS CLOSED AGAINST 90 PSF PSF WIND UPLIFT ZINC PLATED STEEL LATCH STRIKERS ON COVERS

PROPRIETARY AND CONFIDENTIAL: THE INFORMATION CONTAINED IN THIS DRAWING IS THE SOLE PROPERTY OF NYSTROM. ANY REPRODUCTION IN PART OR AS A WHOLE WITHOUT THE WRITTEN PERMISSION OF NYSTROM IS PROHIBITED.

⑧ **HINGES:** ZINC PLATED STEEL WITH STAINLESS STEEL HINGE PINS

⑨ **INSULATION:** 1" Polyiso curb (R5.6), 1" Polyiso cover (R5.6)

⑩ **GASKET:** ADHESIVE BACKED EPDM RUBBER EXTRUSION

⑪ **THERMAL RELEASE MECHANISM:** VENT COVERS OPEN THERMALLY BY HEAT AT FUSIBLE LINK TEMPERATURE 165F°F

⑫ **MANUAL OPERATION:** VENT COVERS OPEN WITH EXTERNAL MANUAL PULL HANDLE, 1/16" DIA SST CABLE AND VENT COVERS OPEN AND CLOSE WITH MANUAL WINCH, 100FT 1/8" DIA CABLE

⑬ **ELECTRICAL RELEASE:** NONE

⑭ **BURGLAR BARS:** None

SMOKE VENT SIZE      "(WIDTH) x      "(LENGTH)  
EFFECTIVE VENTING AREA 80%



PROJECT:

ARCHITECT:

CONTRACTOR:

QTY:

PART#:

nystrom

9300 73rd Avenue North  
Minneapolis, MN 55428

TITLE:

Smoke Vent, SmokEscape,  
  
Galv, Gray Pwd,

	NAME	DATE	SIZE	DWG. NO.	REV
DRAWN	ELW	4/15/14	A		A
RELEASED	ELW	4/15/14	WEIGHT: VARIES		SHEET 1 OF 2

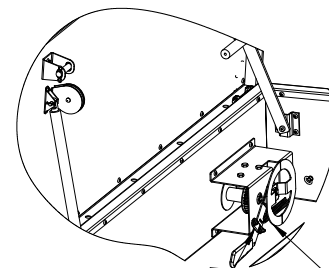
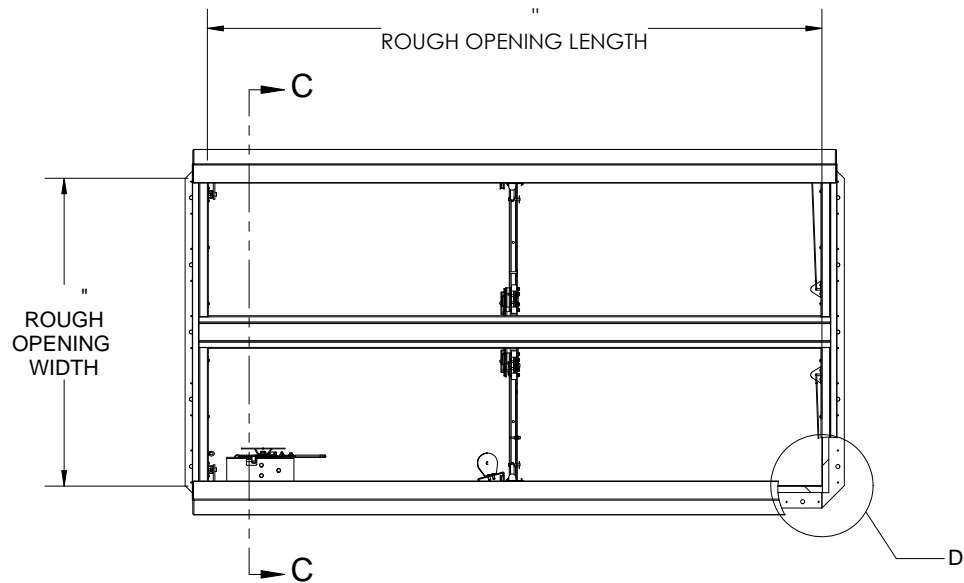

FUSIBLE LINK

UPPER WINCH ASSEMBLY  
TO FACILITATE RESETING AFTER  
THERMAL/EXTERNAL/ELECTRICAL  
MANUAL RELEASE

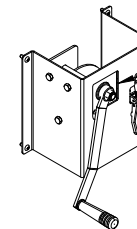

LOWER WINCH ASSEMBLY TO MANUALLY  
OPEN AND CLOSE SMOKE VENTS

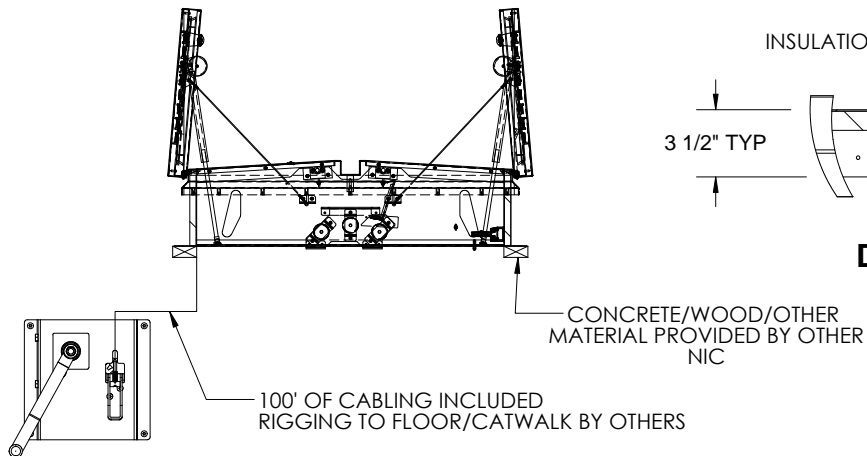
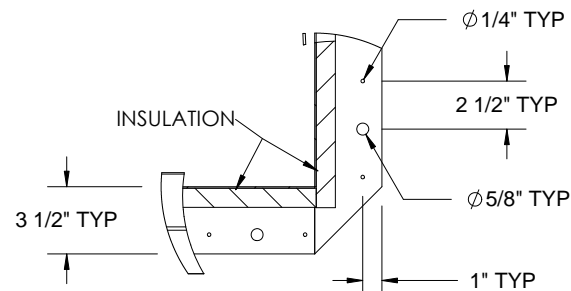
**SECTION C-C****DETAIL D**

				TITLE: Smoke Vent, SmokEscape,	
9300 73rd Avenue North Minneapolis, MN 55428				Galv, Gray Pwd,	
	NAME	DATE	SIZE	DWG. NO.	REV
DRAWN	ELW	4/15/14	A		A
RELEASED	ELW	4/15/14		WEIGHT: VARIES	SHEET 2 OF 2