

# Seismic Elastomeric

## TWIN SEAL SYSTEM (SWNB/W)

The Seismic Elastomeric Twin Seal System offers protection of expansion joints in a seismic event. This system is constructed of two rubber seals and an aluminum slide plate. This system allows for multi-directional movement with a seismic centering bar.



### FEATURES

**SEISMIC MOVEMENT** This seismic system is engineered to accept lateral shear.

**COORDINATING CORNERS** Available with a corner option for a completion solution.

**COMPLEMENTARY SEAL COLORS** Available in four elastomeric seal color options: beige, white, gray or black.

### DETAILS

**MATERIAL** 6063-T6 Aluminum with Rubber Seal

**FINISH** Clear Anodized

#### MOVEMENT

- Thermal: Horizontal and Vertical
- Seismic: Lateral Shear

**MOUNTING** Surface

**JOINT SIZE** 4 inches to 24 inches

**LENGTH** 10 Linear Feet

**APPLICATION** Interior

**INSTALLATION** Wall or Ceiling

**OPTIONS** Seal Color, Moisture Barrier, Fire Barrier

### SEAL COLORS

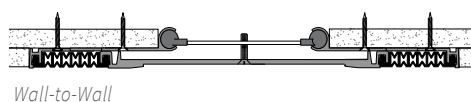

Wall-to-Wall

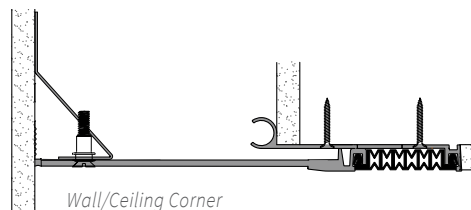

Wall/Ceiling Corner

### MODELS

#### WALL-TO-WALL

MODEL	JOINT SIZE AT MEAN T°F	SYSTEM WIDTH	TOTAL MOVEMENT
SWNB-400	4" (102mm)	11.88" (302mm)	4" (102mm)
SWNB-600	6" (152mm)	15.88" (403mm)	7" (178mm)
SWNB-800	8" (203mm)	17.88" (454mm)	10" (254mm)
SWNB-1000	10" (254mm)	21.88" (556mm)	13" (330mm)
SWNB-1200	12" (305mm)	23.88" (606mm)	16" (406mm)
SWNB-1800	18" (451mm)	33.88" (860mm)	25" (635mm)
SWNB-2000	20" (508mm)	42.88" (1089mm)	34" (864mm)

#### CORNER

MODEL	JOINT SIZE AT MEAN T°F	SYSTEM WIDTH	TOTAL MOVEMENT
SWNB-400W	4" (102mm)	7.94" (202mm)	3.25" (83mm)
SWNB-600W	6" (152mm)	10.94" (278mm)	5.75" (146mm)
SWNB-800W	8" (203mm)	12.94" (329mm)	7.75" (197mm)
SWNB-1000W	10" (254mm)	15.94" (405mm)	11.25" (286mm)
SWNB-1200W	12" (305mm)	17.94" (456mm)	13.25" (337mm)
SWNB-1800W	18" (451mm)	25.63" (651mm)	21" (533mm)
SWNB-2000W	20" (508mm)	33.13" (841mm)	28.5" (724mm)

Additional options available, call for more information.