



# Aluminum

## WALL & CEILING SYSTEM (WJ/W)

Nystrom's Aluminum Wall and Ceiling system is capable of thermal movement. It mounts easily after final wall surface is complete. Standard with a clear anodize finish.

### FEATURES

**COORDINATING CORNERS** Available with corner option for a complete solution.

**ARCHITECTURAL AESTHETICS** The sliding cover plate with a clear anodized finish provides a high-end appearance.

**CONTINUOUS SIGHT LINE** This system can be used on walls, ceilings and corners to provide seamless and continuous aesthetics.

### DETAILS

**MATERIAL** 6063-T6 Aluminum

**FINISH** Clear Anodize

#### MOVEMENT

- Thermal: Horizontal

**MOUNTING** Surface

**JOINT SIZE** 1 inch to 3 inches

**LENGTH** 10 Linear Feet

**APPLICATION** Interior

**INSTALLATION** Wall or Ceiling

**OPTIONS** Moisture Barrier, Fire Barrier

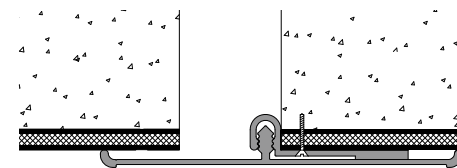

Wall-to-Wall

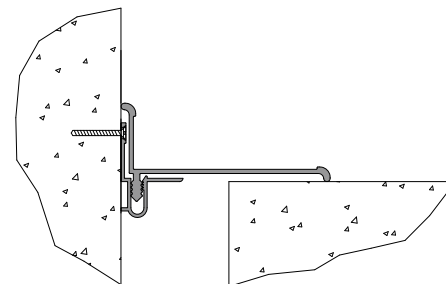

Wall/Ceiling Corner

### MODELS

MODEL	INSTALLATION	JOINT SIZE AT MEAN T°F	SYSTEM WIDTH	TOTAL MOVEMENT
WJ-100	Wall-to-Wall	1" (25mm)	3" (76mm)	0.5" (13mm)
WJ-100W	Wall-to-Ceiling/Corner	1" (25mm)	3" (76mm)	0.5" (13mm)
WJ-150	Wall-to-Wall	1.5" (38mm)	4" (102mm)	2" (51mm)
WJ-200	Wall-to-Wall	2" (51mm)	5.75" (146mm)	2" (51mm)
WJ-200W	Wall-to-Ceiling/Corner	2" (51mm)	5.75" (146mm)	2" (51mm)
WJ-300	Wall-to-Wall	3" (76mm)	7" (178mm)	3" (76mm)
WJ-300W	Wall-to-Ceiling/Corner	3" (76mm)	7" (178mm)	3" (76mm)